



Note: This kit will function in both Single-Zone and Dual-Zone vehicles:

- All HVAC functions will be retained.
- Single-Zone vehicles will only get status feedback of the HVAC functions, while Dual-Zone vehicles can also be controlled through the radio screen.
- Compass is only retained on vehicles equipped with the Uconnect 3 (5" touchscreen).
- The External Speaker is only required in vehicles with safety group features.

MetraOnline.com may be used to assist with dash assembly instructions. Simply enter your Year, Make, Model vehicle into the vehicle fit guide and look for the Dash Kit Installation Instructions.

www.MetraOnline.com



* Chrysler Pioneer Basic Package 2019-UP *

Visit AxxessInterfaces.com for more detailed information about the product and up-to-date vehicle specific applications.

FEATURES

- Designed for select Pioneer receivers
- Provides accessory power (12-volt 10-amp)
- Retains R.A.P. (retained accessory power)
- Provides NAV outputs (parking brake, reverse, speed sense)
- Allows visual of HVAC and gauges on Pioneer screen
- Allows adjustment of HVAC functions through Pioneer screen
- Retains audio controls on the steering wheel
- Allows for auto stop/start override (if equipped)
- Works in both Single and Dual-zone vehicles
- Retains safety chimes
- Designed for amplified or non-amplified vehicles
- Micro-B USB updatable
- Allows the retention and adjustment of the OE Personalization Settings
- Plug-n-Play installation
- Includes radio antenna adapter & antenna adapter for GPS

WIRING & ANTENNA CONNECTIONS

Wiring Harness: Included with Kit

Antenna Adapter: Included with Kit

GPS Antenna Adapter: Included with Kit

TABLE OF CONTENTS

Interface Installation.....	2
TPMS Visual.....	3
Radio Operation.....	4-5
Applicable Radio Models.....	6

TOOLS REQUIRED

- Crimping tool and connectors, or solder gun, solder, and heat shrink • Tape • Wire cutter
- Zip-ties

KIT COMPONENTS

- LD-CH8-PIO • LD-CHRYHAZ2T • LD-CAN3T • Radio interface • PR04AVIC-PIO and PR04-PIORCA Harness
- LD-AX-SPK • AD-EU5 • 40-GPS-PIO

ATTENTION: With the key out of the ignition, disconnect the negative battery terminal before installing this product. Ensure that all installation connections, especially the air bag indicator lights, are plugged in before reconnecting the battery or cycling the ignition to test this product.

NOTE: Refer also to the instructions included with the aftermarket accessory before installing this device.

INTERFACE INSTALLATION

NOTE: LD-CHRYHAZZT connected at the hazard area. Refer to chart to determine which 2 pin to use.



Note: Not used in all applications see chart for more info.

NOTE: LD-CAN-3T refer to chart to determine which 2 pin to use.



LD-CAN-3T

"TBA" WIRES



EXTERNAL SPEAKER

Important: Install the provided speaker in the dash prior to assembling the radio components.

Note: Make sure this is mounted in a location suitable for the driver to hear. (Audio level for the speaker can be changed via the radio, once installed.)



16P 22P

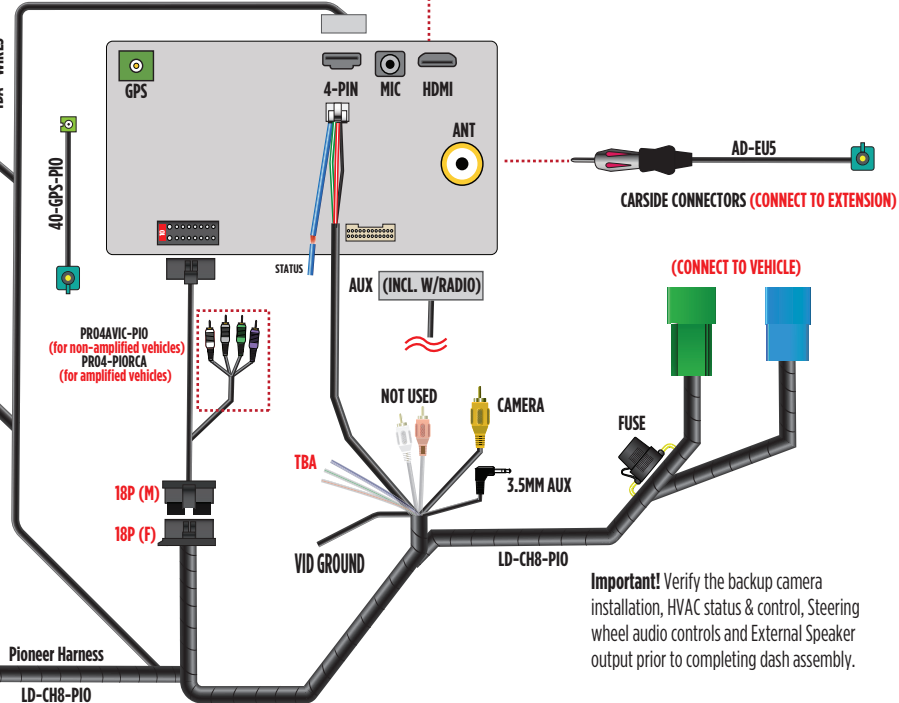

Important! Verify the backup camera installation, HVAC status & control, Steering wheel audio controls and External Speaker output prior to completing dash assembly.

TPMS VISUAL ON PIONEER / LD-CHRYHAZ2T CONNECTION

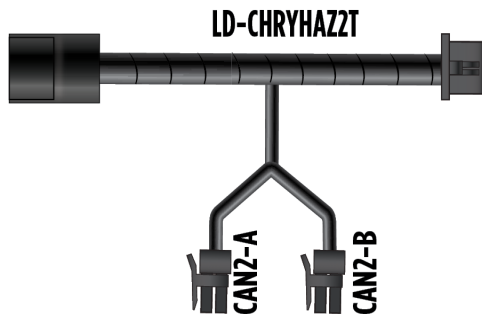

STAR Connector port

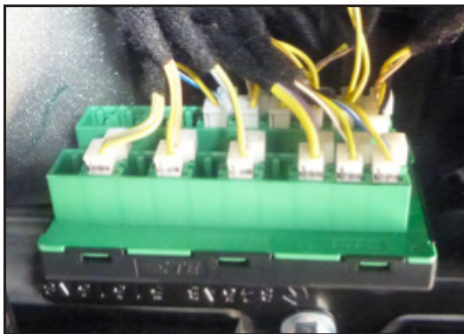

(LD-CHRYHAZ2T) APPLICATIONS CH8						
MAKE	MODEL	FROM	TO	BASIC (NO PLASTIC)	CHRYHAZ2T 2PIN CONNECTION	QUALIFER
DODGE	DURANGO	2021	2023	AXPIOB-CH8	Not needed	DISASSOCIATED SCREEN
RAM	1500	2019	2022	AXPIOB-CH8	A	(DT BODY) RFV RADIO

Make	Model	Qualifier	From	To	CAN3 location
Dodge	Durango	disassociated screen	2021	2023	Driver side kick high
RAM	1500	DT body Disassociated screen	2019	2022	

If equipped with TPMS, and you wish to add the visual to the Pioneer Radio screen:

RADIO OPERATION

Vehicle Selection – Allows you to select the vehicle the radio is being installed in.

- Vehicle type must be selected to activate menu & HVAC functions, as well as steering wheel controls. Press Make to change the vehicle type. Then press Confirm. The radio will then reset and lock in the selected vehicle.

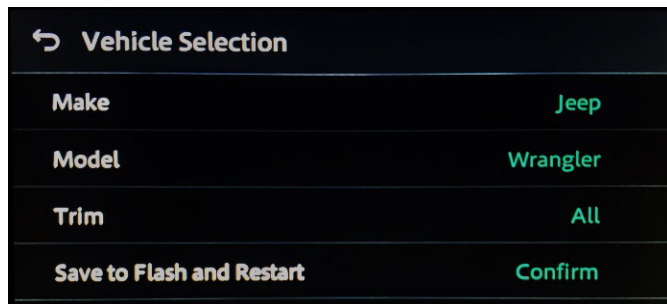
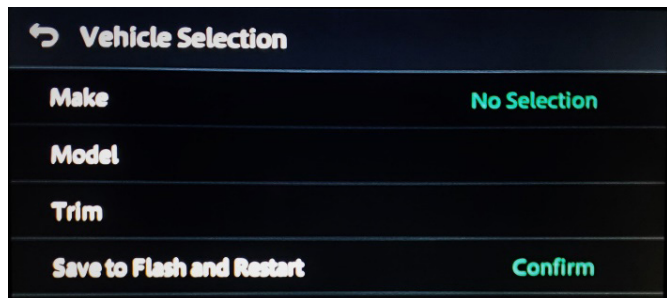

Car Features – The source for accessing all vehicle information and options.

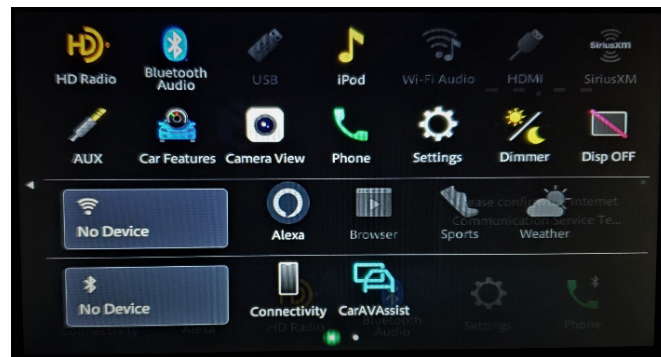
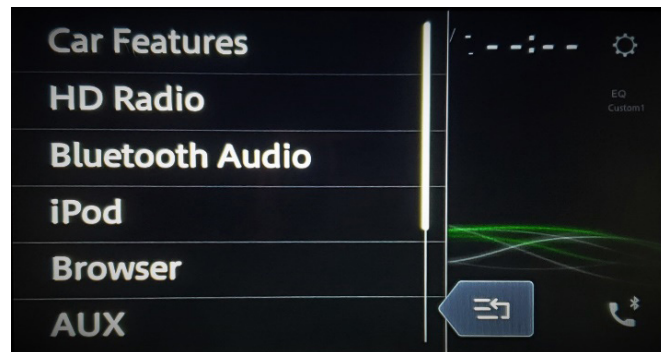

RADIO OPERATION (CONT)

HVAC Operation – HVAC Status and Control Screen.



Vehicle Info Screen – Displays various information of the vehicle (TPMS, Park Position, Lights).

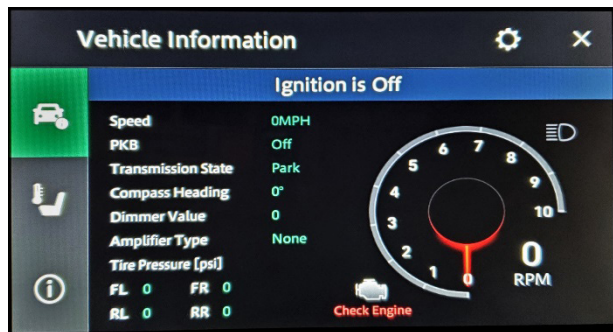

Customizations Menu – Allows full control of vehicle personalization options.

- Access this menu by selecting the gear icon on the previous screenshot.

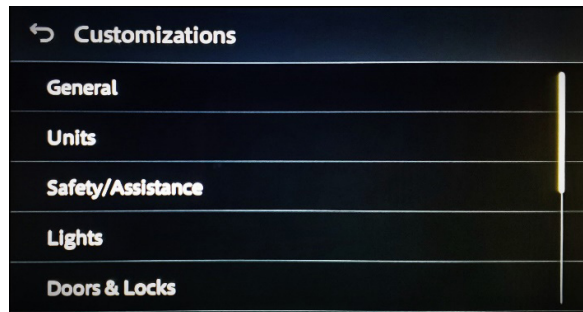

About Screen – Feedback screen for interface software information.

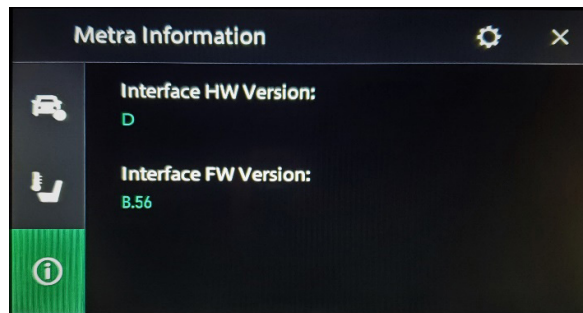

APPLICABLE PIONEER RADIO MODELS

- **DMH-W4660NEX** (6.8" shallow mount for Best Buy)
 - **DMH-W4600NEX** (6.8" shallow mount)
 - **DMH-WC6600NEX** (9" 2 piece radio)
 - **DMH-WT7600NEX** (9" floating radio)
 - **DMH-WT86NEX** (10.1" floating radio)
- **DMH-WT76NEX** (9" floating radio without remote control)
 - **DMH-WT5700NEX** (6.8" 2 piece radio)
 - **DMH-WT8600NEX** (10.1" 2 without the remote)
 - **DMH-WT3800NES** (New 9")





AXPIOB-CH8

INSTALLATION INSTRUCTIONS

Having difficulties? We're here to help.



Contact our Tech Support line at:

386-257-1187



Or via email at:

techsupport@metra-autosound.com

Tech Support Hours (Eastern Standard Time)

Monday - Friday: 9:00 AM - 7:00 PM

Saturday: 10:00 AM - 5:00 PM

Sunday: 10:00 AM - 4:00 PM



**Metra recommends MECP
certified technicians**