

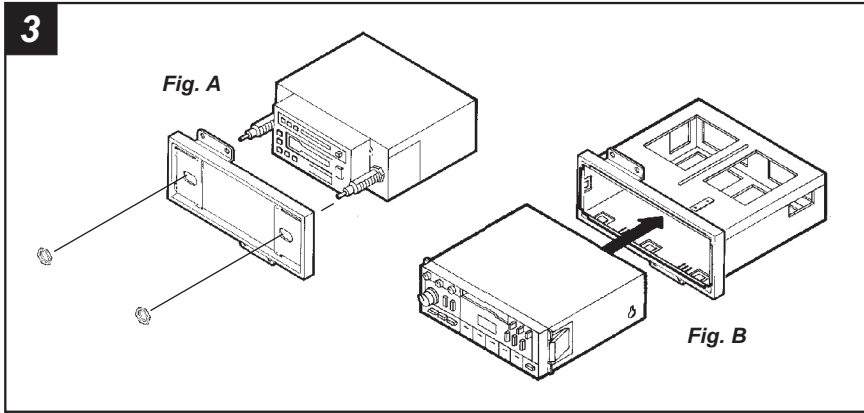

ALL VEHICLES



2-SHAFT HEAD UNITS: Slide the aftermarket head unit into the kit and secure with shaft nuts. (see Fig. A)

DIN HEAD UNITS: Cut and remove the shaft supports. Slide the DIN cage into the **Radio Housing** and secure by bending the metal locking tabs down. Slide the aftermarket head unit into the cage until secure. (see Fig. B)

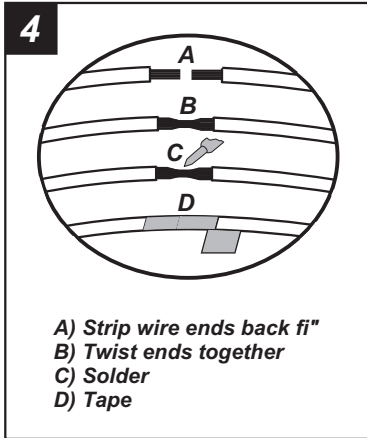

- A) Strip wire ends back 5/8"
- B) Twist ends together
- C) Solder
- D) Tape

Locate the factory wiring harness in the dash. Metra recommends using the proper mating adaptor and making connections as shown. (Isolate and individually tape off the ends of any unused wires to prevent electrical short circuit).

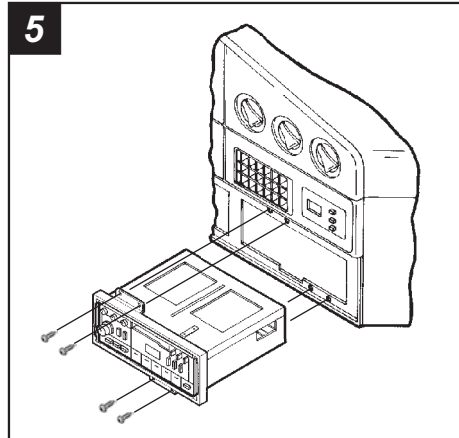

Re-connect the battery terminal and test the unit for proper operation. Mount the head unit/kit assembly to the sub-dash with those screws previously removed.

KIT COMPONENTS

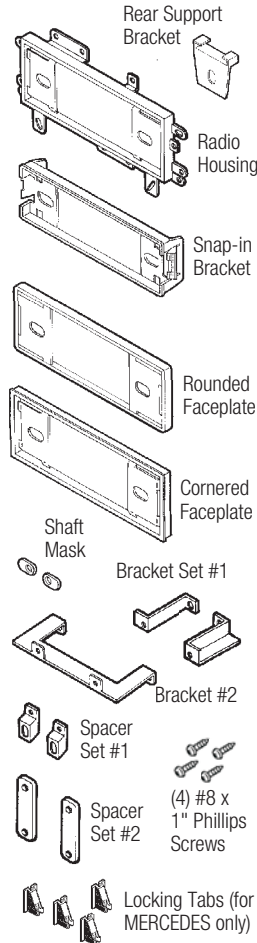

TOOLS REQUIRED

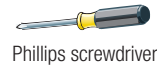

86-5618 - Head unit removal keys

**99-5510
INSTALLATION
INSTRUCTIONS**

APPLICATIONS

**FORD/JEEP/LINCOLN/MAZDA/MERCURY 1975-00
(SEE INSIDE FOR SPECIFIC APPLICATIONS)**



1-800-221-0932

www.metraonline.com

© COPYRIGHT 2001 METRA ELECTRONICS

TABLE OF CONTENTS

CAR	PAGE	CAR	PAGE	CAR	PAGE
AMC		MERCURY		HONDA (cont.)	
Alliance 1983-87	1	Capri XR2 1991-94	19	Del Sol 1993-97	21
Encore 1983-87	1	Cougar 1989-97	11	Prelude 1983-87	21
GTA 1983-87	1	Cougar 1983-88	11	JAGUAR	
FORD		Grand Marquis 1991-94	5	XJ6 1986-93	21
Aerostar 1992-97	1	Grand Marquis 1979-90	5	LANCIA	
Aerostar 1985-91	2	Lynx 1985-87	7	Beta 1979-81	21
Aspire 1995-97	2	Mystique 1995-00	4	MASERATI	
Bronco 1992-96	7	Marquis 1979-81	5	Spyder 1985-90	21
Bronco (full) 1987-91	3	Sable 1990-95	9	MERCEDES	
Bronco II 1989-90	3	Sable 1986-89	10	240/280/300/380/420/450	
Bronco II 1983-88	4	Topaz 1989-94	10	500SLC/SEL 1970-96	19
Contour 1995-00	4	Tracer 1991-96	6	MINI	
Crown Victoria 1992-94	5	Tracer (hatch) 1988-90	20	Mighty Max 1987-96	21
Crown Victoria 1979-90	5	Villager 1993-95	20	Mirage 1993-96	21
Econoline 1992-96	6	NISSAN		PEUGEOT	
Econoline 1975-91	6	Quest 1993-95	20	405 1989-91	21
Escort 1991-96	6	ADDITIONAL VEHICLES:		505 1984-91	21
Escort 1985-90	7	ACURA		PONTIAC	
Explorer 1991-94	3	Integra 1986-89	21	LeMans 1988-93	21
F-Series Pickup 1992-96	7	Legend 1986-89	21	PORSCHE	
F-Series Pickup 1987-91	3	ALFA ROMEO		911 1973-99	21
Festiva 1988-93	8	Milano 1986-89	21	924 1987-89	21
LTD 1982-91	5	Spider Veloce 1987-93	21	924S 1987-89	21
Mustang 1994-00	8	S4 1992-93	21	928 1994-94	21
Probe 1993-97	9	AUDI		944 1984-93	21
Ranger (mini) 1989-94	3	80/90 1988-96	21	968 1992-96	21
Ranger (mini) 1985-88	4	100/200 1989-95	21	RENAULT	
Taurus 1990-95	9	4000 1980-87	21	Alliance 1982-87	21
Taurus 1986-89	10	5000 1980-85	21	Encore 1982-85	21
Tempo 1989-94	10	S4 1992-93	21	Fuego 1982-85	21
Thunderbird 1989-97	11	BMW		LeCar 1978-83	21
Thunderbird 1983-88	11	3-Series 1977-98	21	18i 1979-83	21
Windstar 1995-98	12	5-Series 1975-96	21	SAAB	
JEEP		6-Series 1977-89	21	900 1979-98	21
Cherokee 1984-95	12	7-Series 1978-01	21	9000 1986-98	21
Cherokee 1996	13	8-Series 1990-91	21	STERLING	
Commanche 1986-92	12	23-Series 1997-02	21	825 1988-92	21
Grand Wagoneer 1987-95	13	DAIHATSU		827 1988-92	21
Wagoneer 1984-96	12	Charade 1989-92	21	SUZUKI	
Wrangler 1984-96	14	DODGE		Samurai 1986-95	21
LINCOLN		Colt 1993-94	21	Sidekick 1989-91	21
Continental 1988-94	14	D50 Pickup 1987-93	21	Swift 1989-91	21
Continental 1985-87	15	EAGLE		X-90 1996-99	21
Mark VII 1990-92	14	Summit 1993-94	21	VOLKSWAGEN	
Mark VII 1984-89	15	FIAT		Bus 1968-79	21
Mark VIII 1993-95	16	Brava 1979-83	21	Cabrio 1995-01	21
Town Car 1990-97	14	Spider 1970-83	21	Cabriolet 1985-93	21
Town Car 1985-89	16	Strada 1977-83	21	Dasher 1976-81	21
MAZDA		X19 1985-88	21	Fox 1987-93	21
B-Series Pickup 1994	3	GEO		Golf 1985-00	21
626 1993-01	18	Metro 1989-91	21	Passat 1990-97	21
MPV 1996-98	17	Tracker 1989-91	21	Pickup 1980	21
MX3 1992-96	17	HONDA		Rabbit 1980-84	21
MX6 1993-97	18	Accord 1982-89	21	Scirocco 1981-87	21
Navajo 1991-94	3	CRX 1984-91	21	Super Beetle 1973-79	21
Protege 1995-00	18	Civic 1982-95	21	Quantum 1982-88	21
				Vanwagon 1980-92	21

ALL VEHICLES

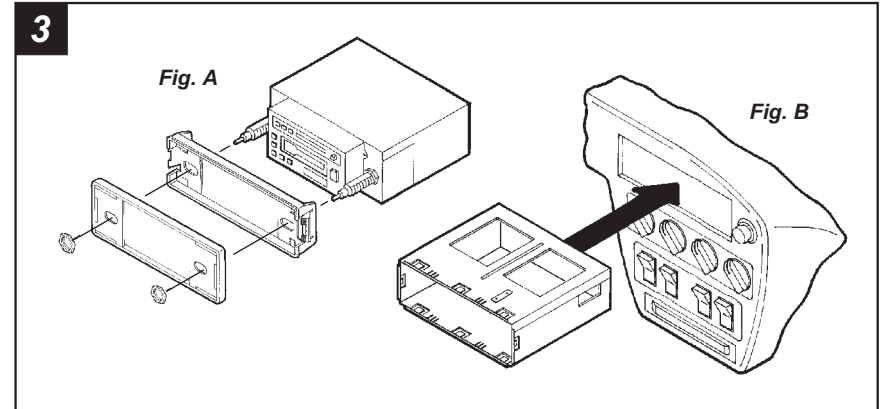

2-SHAFT HEAD UNITS: Attach the **Faceplate** to the **Snap-in Bracket**. (If an aftermarket unit with upper-shaft locations is being installed, cut and remove the upper-shaft tabs from the shaft holes in the Snap-in Bracket). Slide the aftermarket head unit into the kit and secure with shaft nuts. (see Fig. A)

DIN HEAD UNITS: Slide the DIN cage into the dash opening and secure by bending the metal locking tabs down. (see Fig. B)

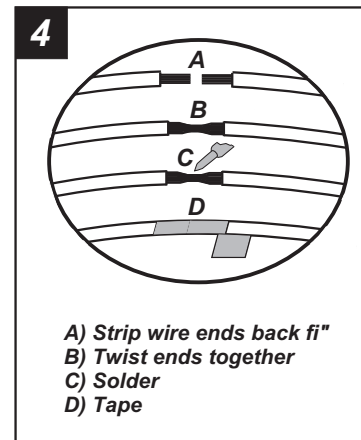

- A) Strip wire ends back fi"
- B) Twist ends together
- C) Solder
- D) Tape

Locate the factory wiring harness in the dash. Metra recommends using the proper mating adaptor and making connections as shown. (Isolate and individually tape off the ends of any unused wires to prevent electrical short circuit).

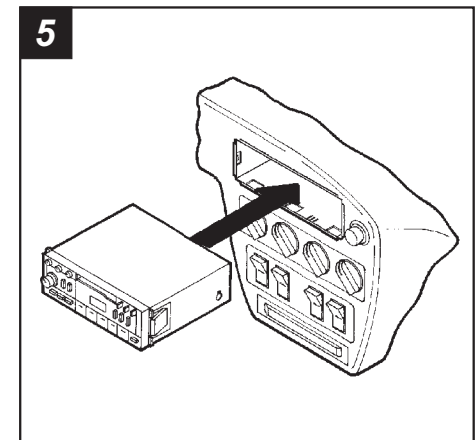

Re-connect the battery terminal and test the unit for proper operation.
2-SHAFT HEAD UNITS: Snap the head unit/kit assembly into the dash opening.
DIN HEAD UNITS: Slide the aftermarket head unit into the mounted cage until secure.



MERCURY Tracer (hatchback) 1988-90

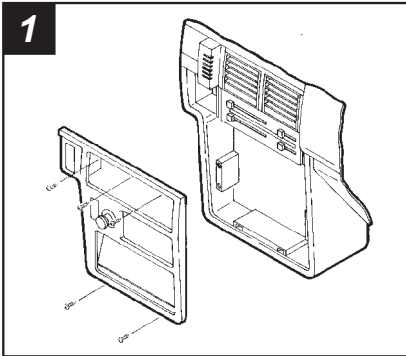

1 Disconnect the negative battery terminal to prevent an accidental short circuit. Remove (3) Phillips screws from the top of the dash trim bezel. Remove the ashtray and (2) Phillips screws from the bottom of the bezel. Remove (4) Phillips screws securing the factory head unit and disconnect the wiring.

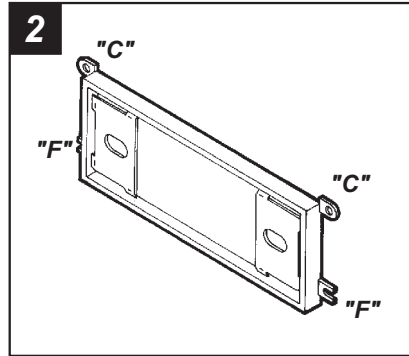

2 Cut and remove all mounting tabs on the **Radio Housing** EXCEPT tabs "C" and "F". The mounting tabs can be identified by the stamped letter on the back of each tab. Skip to the *Installation Instructions for ALL VEHICLES on Page#22*.

AMC Alliance / Encore / GTA 1983-87

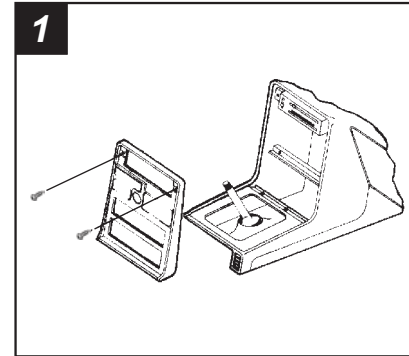

1 Disconnect the negative battery terminal to prevent an accidental short circuit. Gently remove the climate control trim panel and (2) Phillips screws exposed. Lift up on the dash trim bezel and remove. Remove (2) screws securing the factory head unit and disconnect the wiring.

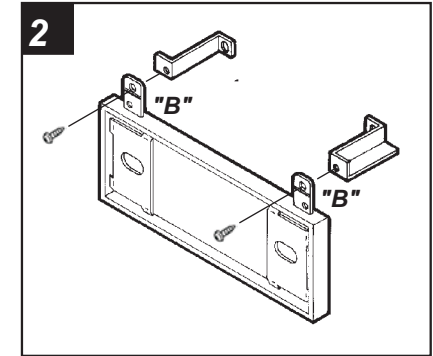

2 Cut and remove all mounting tabs on the **Radio Housing** EXCEPT tabs "B". The mounting tabs can be identified by the stamped letter on the back of each tab. Mount **Bracket Set #1** to the back of the mounting tabs with (2) #8 x 1" Phillips screws supplied. Skip to the *Installation Instructions for ALL VEHICLES on Page #22*.

MERCURY Villager / NISSAN Quest 1993-95

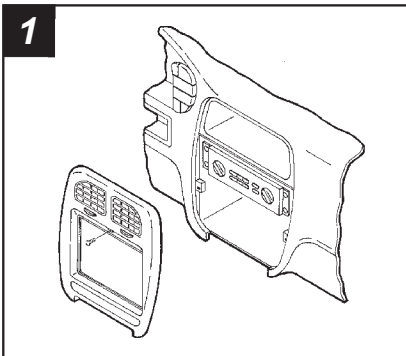

1 Disconnect the negative battery terminal to prevent an accidental short circuit. Remove (1) screw above the climate controls. Unclip the dash trim bezel. Using Metra's **86-5618**, pull the factory head unit from the dash and disconnect the wiring.

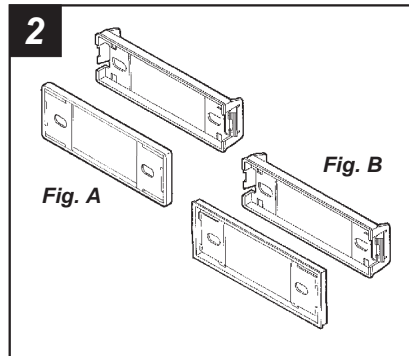

2 Locate the **Snap-in Bracket and Rounded Faceplate** (see Fig. A) OR the **Snap-in Bracket and Cornered Faceplate** (see Fig. B). Skip to the *Installation Instructions for ALL VEHICLES on Page#21*.

FORD Aerostar 1992-97

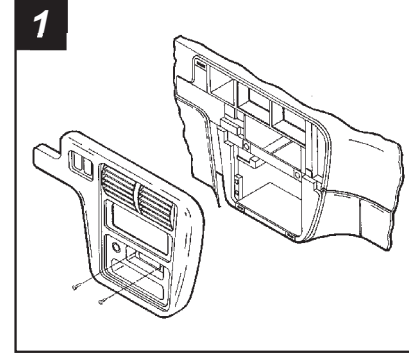

1 Disconnect the negative battery terminal to prevent an accidental short circuit. Remove (2) screws from the steering column trim panel and (2) screws from the ashtray cavity. Unclip the dash trim bezel. Using Metra's **86-5618**, pull the factory head unit unit from the dash and disconnect the wiring.

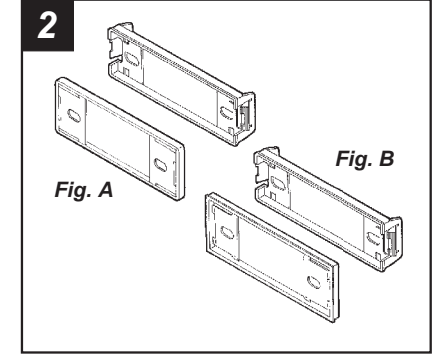

2 Locate the **Snap-in Bracket and Rounded Faceplate** (see Fig. A) OR the **Snap-in Bracket and Cornered Faceplate** (see Fig. B). Skip to the *Installation Instructions for ALL VEHICLES on Page#21*.

FORD Aerostar 1985-91

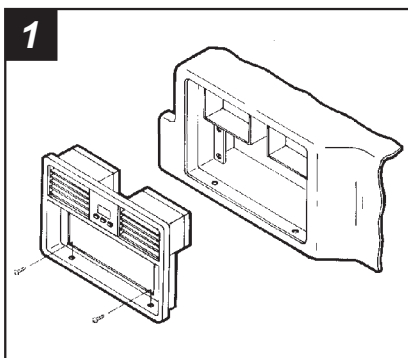

1 Disconnect the negative battery terminal to prevent an accidental short circuit. Remove (2) Phillips screws from the base of the dash trim bezel. Pry down on the (2) tabs located at the top of the dash trim bezel and remove the bezel. Remove (4) screws securing the factory head unit and disconnect the wiring.

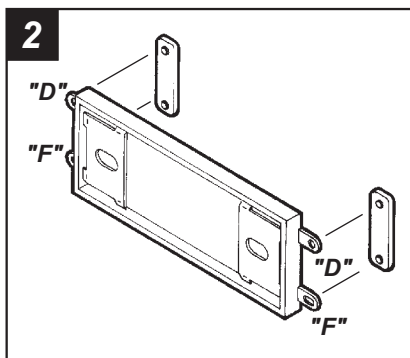

2 Cut and remove all mounting tabs on the **Radio Housing** EXCEPT tabs "D" and "F". The mounting tabs can be identified by the stamped letter on the back of each tab. Locate **Spacer Set #2**. (The Spacers must be placed behind the mounting tabs during installation in step #5). Skip to the *Installation Instructions for ALL VEHICLES on Page #22*.

MERCEDES (all models)

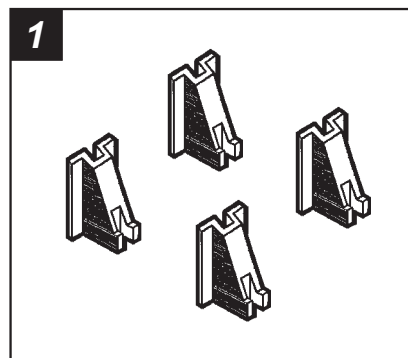

1 Locate the (4) **Locking Tabs** supplied in the kit.

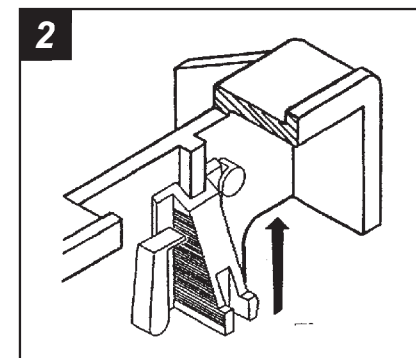

2 Slide the **Locking Tabs** onto the guides located on the front corners of the **Snap-in Bracket**. Skip to the *Installation Instructions for ALL VEHICLES on Page #21*.

FORD Aspire 1995-97

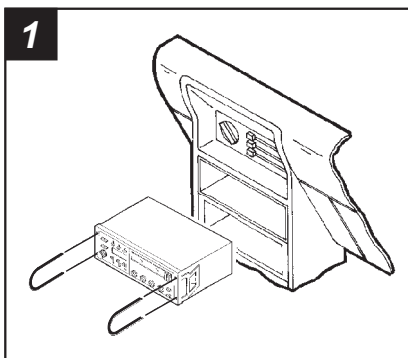

1 Disconnect the negative battery terminal to prevent an accidental short circuit. Using Metra's **86-5618**, pull the factory head unit from the dash and disconnect the wiring.

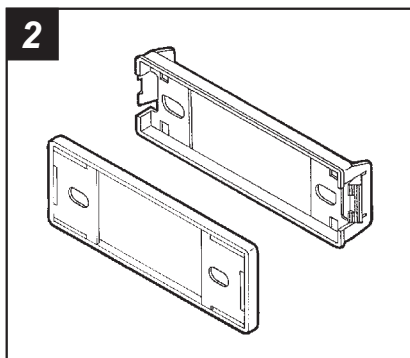

2 Locate the **Snap-in Bracket** and **Rounded Faceplate**. Skip to the *Installation Instructions for ALL VEHICLES on Page #21*.

MERCURY Capri XR2 1991-94

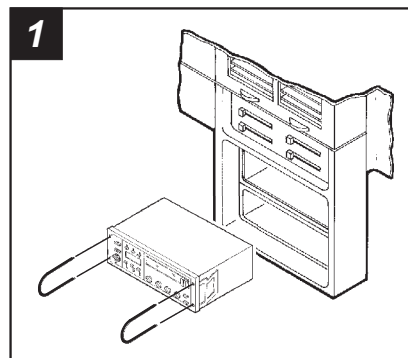

1 Disconnect the negative battery terminal to prevent an accidental short circuit. Using Metra's **86-5618**, pull the factory head unit from the dash and disconnect the wiring.

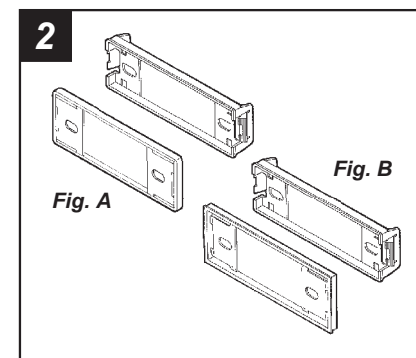

2 Locate the **Snap-in Bracket** and **Rounded Faceplate** (see Fig. A) OR the **Snap-in Bracket** and **Cornered Faceplate** (see Fig. B). Skip to the *Installation Instructions for ALL VEHICLES on Page #21*.

MAZDA MX6 1993-97 / 626 1993-01

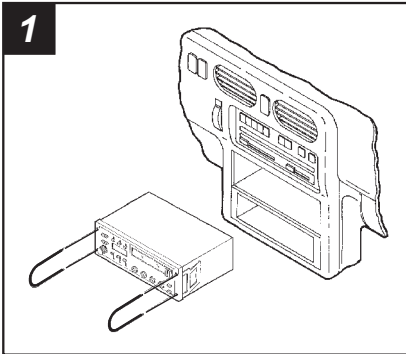

1 Disconnect the negative battery terminal to prevent an accidental short circuit. Using Metra's **86-5618**, pull the factory head unit from the dash and disconnect the wiring.

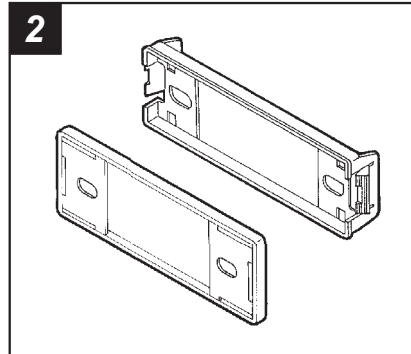

2 Locate the **Snap-in Bracket** and **Rounded Faceplate**. Skip to the *Installation Instructions for ALL VEHICLES on Page #21*.

FORD Bronco (full size) / F-Series Pickup 1987-91

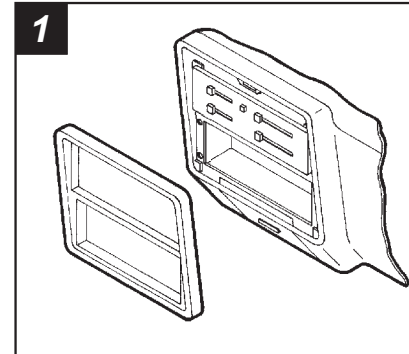

1 Disconnect the negative battery terminal to prevent an accidental short circuit. Carefully pull and remove the dash trim bezel. Remove (4) screws securing the factory head unit and disconnect the wiring.

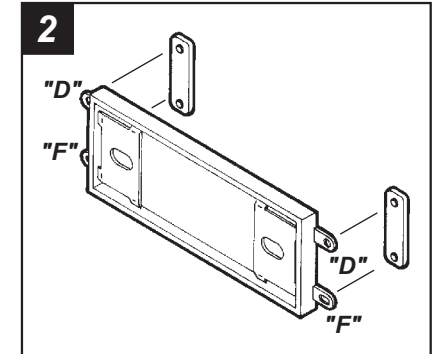

2 Cut and remove all mounting tabs on the **Radio Housing** EXCEPT tabs "D" and "F". The mounting tabs can be identified by the stamped letter on the back of each tab. Locate **Spacer Set #2**. (The Spacers must be placed behind the mounting tabs during installation in step #5). Skip to the *Installation Instructions for ALL VEHICLES on Page #22*.

MAZDA Protege 1995-00

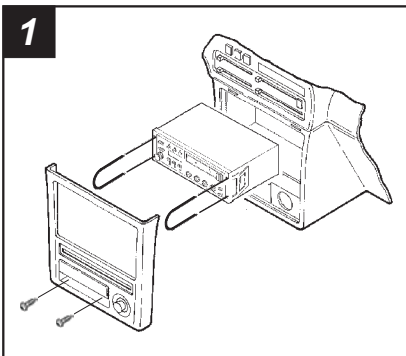

1 Disconnect the negative battery terminal to prevent an accidental short circuit. Remove the ashtray and (2) screws from the ashtray cavity. Using Metra's **86-5618**, pull the factory head unit from the dash and disconnect the wiring.

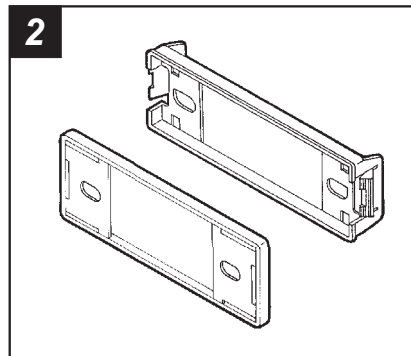

2 Locate the **Snap-in Bracket** and **Rounded Faceplate**. Skip to the *Installation Instructions for ALL VEHICLES on Page #21*.

FORD Bronco II 1989-90 / Explorer 1991-94 / Ranger 1989-94 MAZDA Navajo 1991-94 / B-Series Pickup 1994

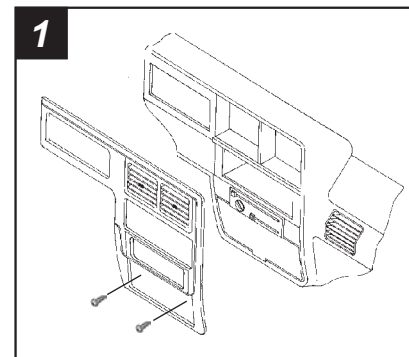

1 Disconnect the negative battery terminal to prevent an accidental short circuit. Remove the ashtray and (2) screws exposed in the ashtray cavity. Using Metra's **86-5618**, pull the factory head unit from the dash and disconnect the wiring.

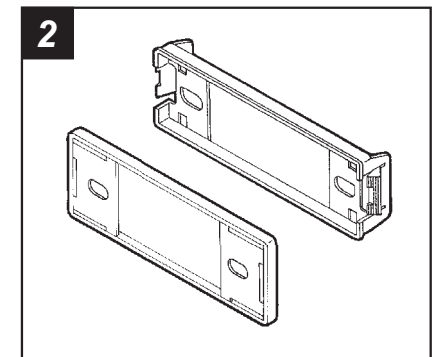

2 Locate the **Snap-in Bracket** and **Rounded Faceplate**. Skip to the *Installation Instructions for ALL VEHICLES on Page #21*.

FORD Bronco II / Ranger 1985-88

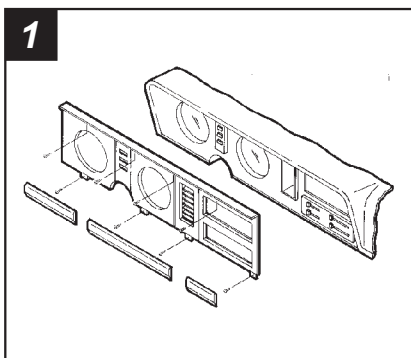

1 Disconnect the negative battery terminal to prevent an accidental short circuit. Remove (4) Phillips screws from the top edge of the dash trim bezel. Remove the light switch knob, cigarette lighter and ashtray. Unsnap the molding located below the dash trim bezel and remove (4) screws exposed. Remove (4) screws securing the factory head unit and disconnect the wiring.

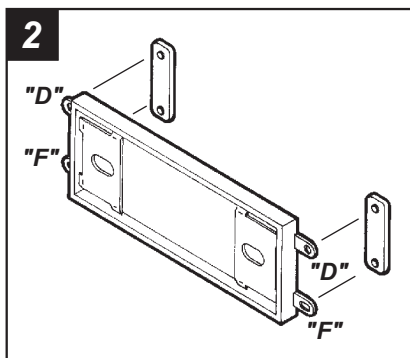

2 Cut and remove all mounting tabs on the **Radio Housing** EXCEPT tabs "D" and "F". The mounting tabs can be identified by the stamped letter on the back of each tab. Locate **Spacer Set #2**. (The Spacers must be placed behind the mounting tabs during installation in step #5). Skip to the *Installation Instructions for ALL VEHICLES on Page #22*.

MAZDA MPV 1996-98

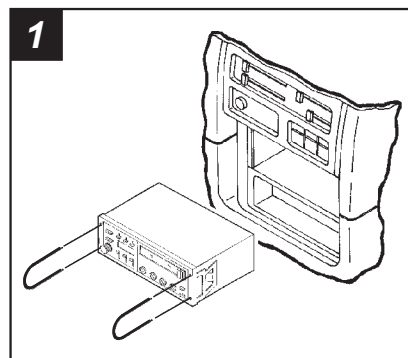

1 Disconnect the negative battery terminal to prevent an accidental short circuit. Unsnap the side trim pieces from the factory head unit. Using Metra's **86-5618**, pull the unit from the dash and disconnect the wiring.

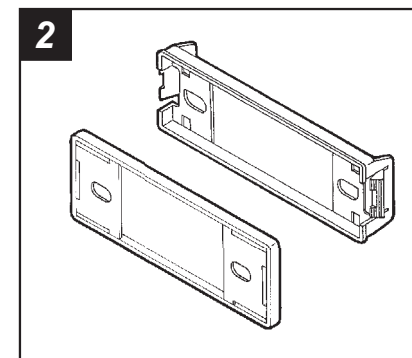

2 Locate the **Snap-in Bracket** and **Rounded Faceplate**. Skip to the *Installation Instructions for ALL VEHICLES on Page #21*.

FORD Contour 1995-00 / MERCURY Mystique 1995-

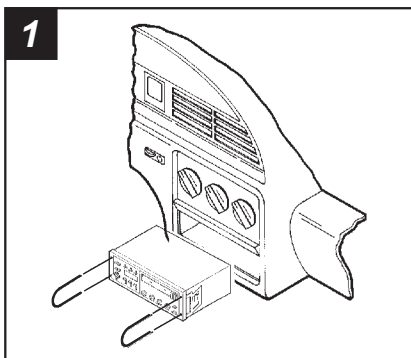

1 Disconnect the negative battery terminal to prevent an accidental short circuit. Using Metra's **86-5618**, pull the factory head unit from the dash and disconnect the wiring.

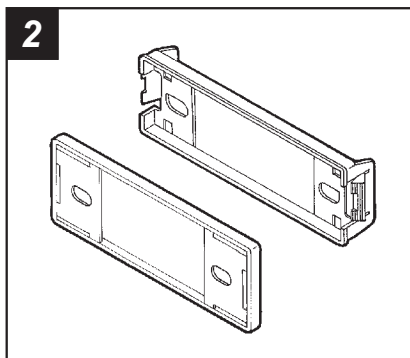

2 Locate the **Snap-in Bracket** and **Rounded Faceplate**. Skip to the *Installation Instructions for ALL VEHICLES on Page #21*.

MAZDA MX3 1992-96

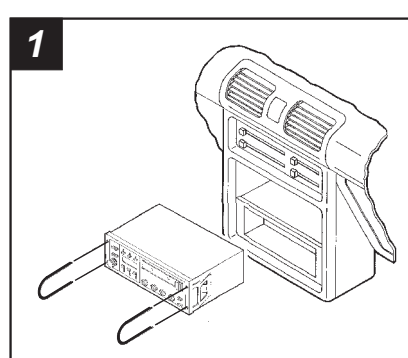

1 Disconnect the negative battery terminal to prevent an accidental short circuit. Using Metra's **86-5618**, pull the factory head unit from the dash and disconnect the wiring.

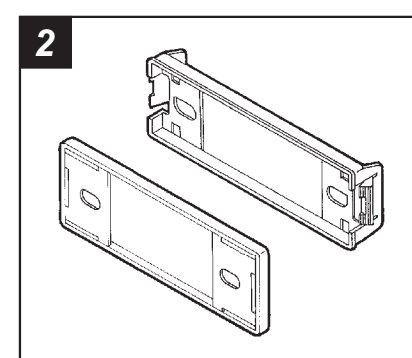

2 Locate the **Snap-in Bracket** and **Rounded Faceplate**. Skip to the *Installation Instructions for ALL VEHICLES on Page #21*.

LINCOLN Mark VIII 1993-95

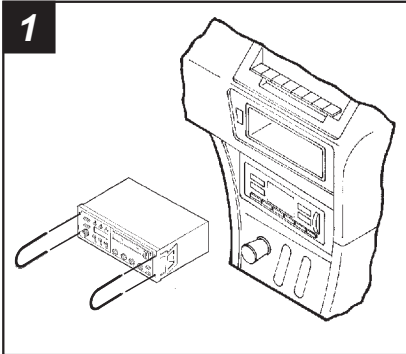

1
Disconnect the negative battery terminal to prevent an accidental short circuit. Using Metra's **86-5618**, pull the factory head unit from the dash and disconnect the wiring.

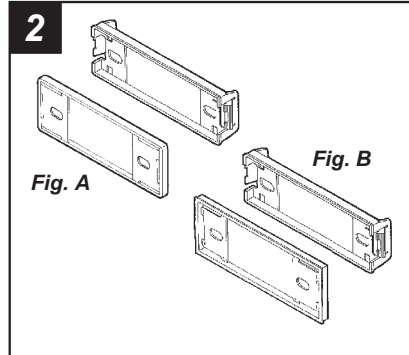

2
Locate the **Snap-in Bracket** and **Rounded Faceplate** (see Fig. A) OR the **Snap-in Bracket** and **Cornered Faceplate** (see Fig. B). Skip to the *Installation Instructions for ALL VEHICLES* on Page #21.

LINCOLN Town Car 1984-89

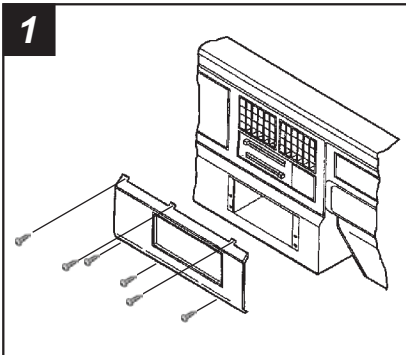

1
Disconnect the negative battery terminal to prevent an accidental short circuit. Remove (3) #8 Phillips screws from the bottom of the radio trim bezel. Unsnap the plastic strip located above the bezel and remove (3) Phillips screws exposed. Gently pull the instrument cluster trim bezel away from the dash and remove the radio trim bezel. Remove (3) hex-head screws securing the factory head unit and disconnect the wiring.

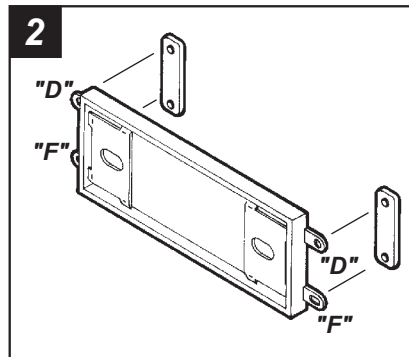

2
Cut and remove all mounting tabs on the **Radio Housing** EXCEPT tabs "D" and "F". The mounting tabs can be identified by the stamped letter on the back of each tab. Locate **Spacer Set #2**. (The Spacers must be placed behind the mounting tabs during installation in step #5). Skip to the *Installation Instructions for ALL VEHICLES* on Page #22.

FORD Crown Victoria / LTD 1979-90 MERCURY Grand Marquis / Marquis 1979-90

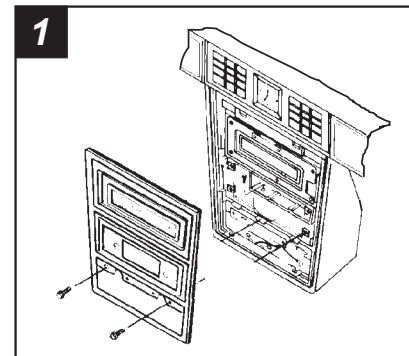

1
Disconnect the negative battery terminal to prevent an accidental short circuit. Open the ashtray and remove (2) Phillips screws securing the dash trim bezel. Remove (4) screws securing the factory head unit and disconnect the wiring.

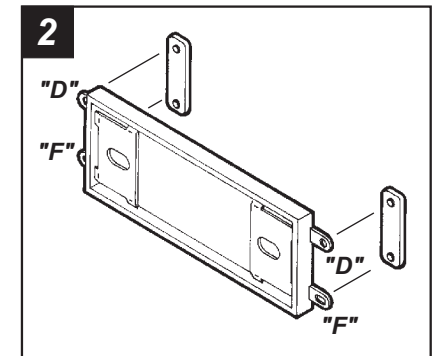

2
Cut and remove all mounting tabs on the **Radio Housing** EXCEPT tabs "D" and "F". The mounting tabs can be identified by the stamped letter on the back of each tab. Locate **Spacer Set #2**. (The Spacers must be placed behind the mounting tabs during installation in step #5). Skip to the *Installation Instructions for ALL VEHICLES* on Page #22.

FORD Crown Victoria 1991-94 MERCURY Grand Marquis 1991-94

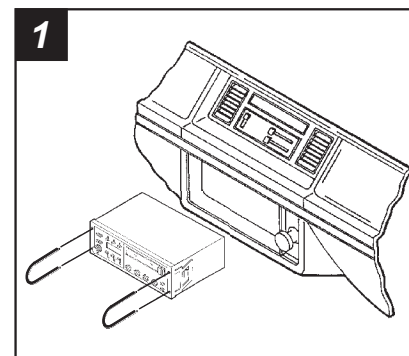

1
Disconnect the negative battery terminal to prevent an accidental short circuit. Using Metra's **86-5618**, pull the factory head unit from the dash and disconnect the wiring.

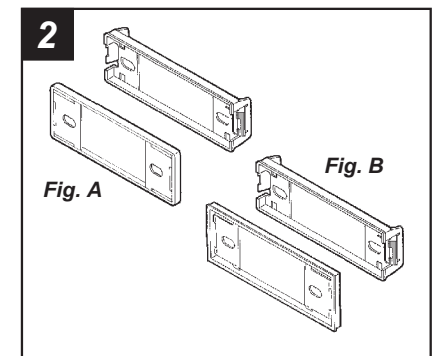

2
Locate the **Snap-in Bracket** and **Rounded Faceplate** (see Fig. A) OR the **Snap-in Bracket** and **Cornered Faceplate** (see Fig. B). Skip to the *Installation Instructions for ALL VEHICLES* on Page #21.

FORD Econoline 1992-96

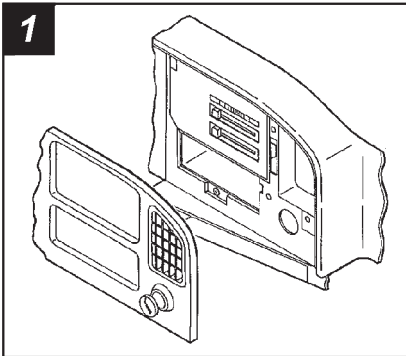

1 Disconnect the negative battery terminal to prevent an accidental short circuit. Remove the light switch knob and unscrew the surrounding trim. Remove the cupholder and the screws exposed in the cupholder cavity. Unsnap the (2) trim bezel inserts and remove the screws exposed. Remove the lower steering column trim panel and unclip the dash trim bezel. Using Metra's **86-5618**, pull the factory head unit from the dash and disconnect the wiring.

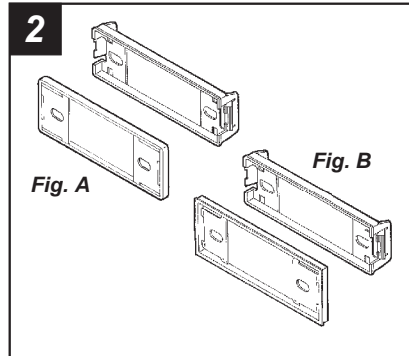

2 Locate the **Snap-in Bracket** and **Rounded Faceplate** (see Fig. A) OR the **Snap-in Bracket** and **Cornered Faceplate** (see Fig. B). Skip to the *Installation Instructions for ALL VEHICLES on Page#21*.

LINCOLN Continental 1985-87

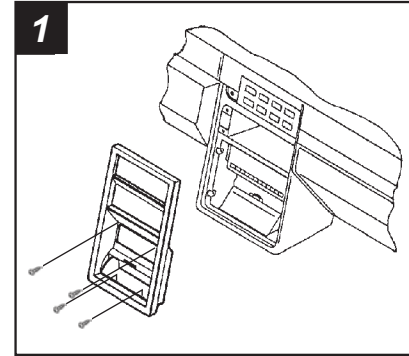

1 Disconnect the negative battery terminal to prevent an accidental short circuit. Remove (2) #8 Phillips screws below the radio opening. Open the ashtray and remove (2) #8 Phillips screws exposed (it is NOT necessary to remove the center screw). Unclip and remove the dash trim bezel. Remove (4) hex-head screws securing the factory head unit and disconnect the wiring.

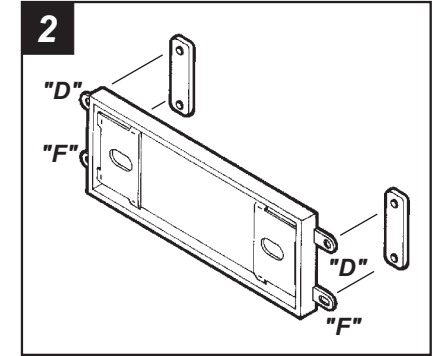

2 Cut and remove all mounting tabs on the **Radio Housing** EXCEPT tabs "D" and "F". The mounting tabs can be identified by the stamped letter on the back of each tab. Locate **Spacer Set #2**. (The Spacers must be placed behind the mounting tabs during installation in step #5). Skip to the *Installation Instructions for ALL VEHICLES on Page#22*.

FORD Escort / MERCURY Tracer 1991-96

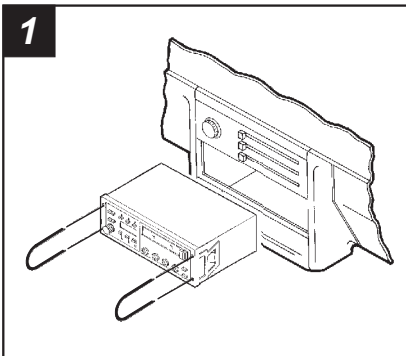

1 Disconnect the negative battery terminal to prevent an accidental short circuit. Using Metra's **86-5618**, pull the factory head unit from the dash and disconnect the wiring.

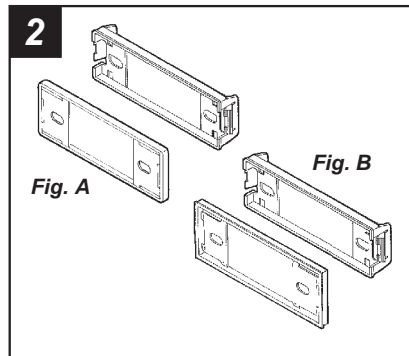

2 Locate the **Snap-in Bracket** and **Rounded Faceplate** (see Fig. A) OR the **Snap-in Bracket** and **Cornered Faceplate** (see Fig. B). Skip to the *Installation Instructions for ALL VEHICLES on Page#21*.

LINCOLN Mark VII 1984-89

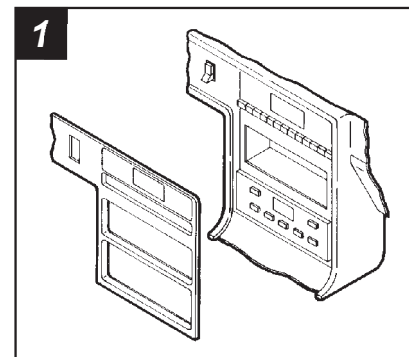

1 Disconnect the negative battery terminal to prevent an accidental short circuit. Gently pry out on the dash trim bezel and remove. Remove (4) 5mm hex-head sheet metal screws securing the factory head unit and disconnect the wiring.

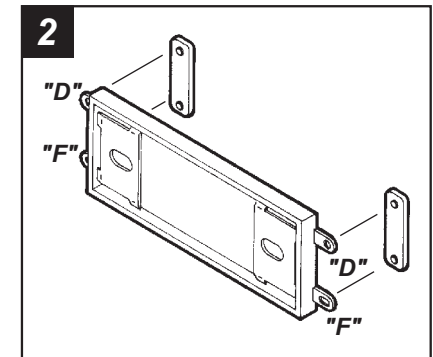

2 Cut and remove all mounting tabs on the **Radio Housing** EXCEPT tabs "D" and "F". The mounting tabs can be identified by the stamped letter on the back of each tab. Locate **Spacer Set #2**. (The Spacers must be placed behind the mounting tabs during installation in step #5). Skip to the *Installation Instructions for ALL VEHICLES on Page#22*.

JEEP Wrangler 1986-96

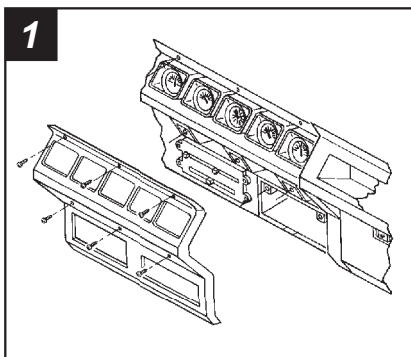

1
Disconnect the negative battery terminal to prevent an accidental short circuit. Remove (6) Phillips screws from the face of the dash trim bezel. Remove the bezel. Remove (2) screws securing the factory head unit and disconnect the wiring.

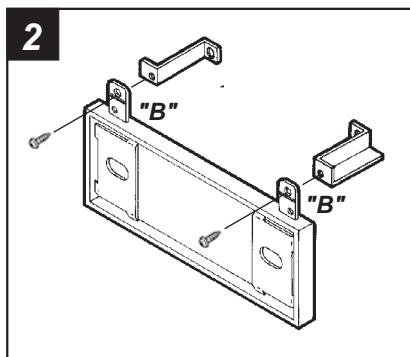

2
Cut and remove all mounting tabs on the **Radio Housing** EXCEPT tabs "B". The mounting tabs can be identified by the stamped letter on the back of each tab. Mount **Bracket Set #1** to the back of the mounting tabs with (2) #8 x 1" Phillips screws supplied. Skip to the Installation Instructions for ALL VEHICLES on Page #22.

FORD Escort / MERCURY Lynx 1985-90

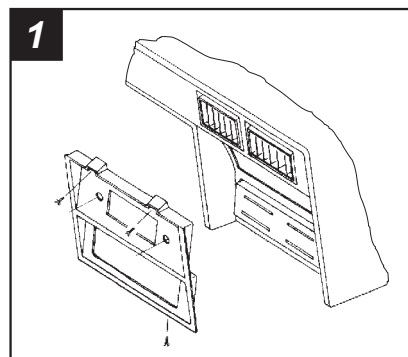

1
Disconnect the negative battery terminal to prevent an accidental short circuit. Remove (4) screws from the top edge of the dash trim bezel. Remove (2) screws from the bottom edge of the dash trim bezel. Remove the climate control knobs and remove the bezel. Remove (4) hex-head screws securing the factory head unit and disconnect the wiring.

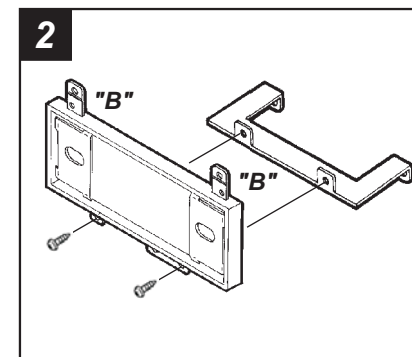

2
Cut and remove all mounting tabs on the **Radio Housing** EXCEPT tabs "B". The mounting tabs can be identified by the stamped letter on the back of each tab. Mount **Bracket #2** to the bottom of the Housing with (2) #8 x 1" Phillips Screws supplied. Skip to the Installation Instructions for ALL VEHICLES on Page #22.

LINCOLN Continental 1988-94 / Mark VII 1990-92 Town Car 1990-94

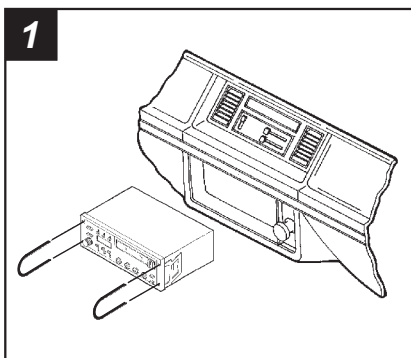

1
Disconnect the negative battery terminal to prevent an accidental short circuit. Using Metra's 86-5618, pull the factory head unit from the dash and disconnect the wiring.

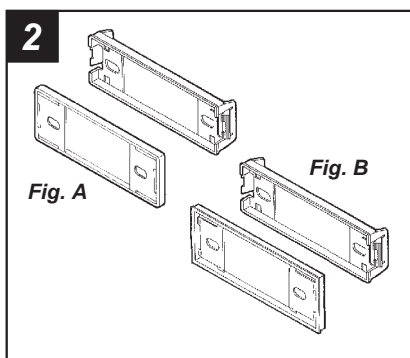

2
Locate the **Snap-in Bracket** and **Rounded Faceplate** (see Fig. A) OR the **Snap-in Bracket** and **Cornered Faceplate** (see Fig. B). Skip to the Installation Instructions for ALL VEHICLES on Page#21.

FORD F-Series Pickup / Bronco 1992-96

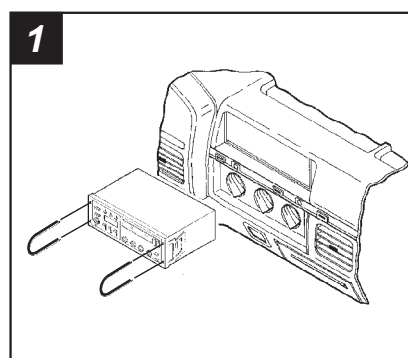

1
Disconnect the negative battery terminal to prevent an accidental short circuit. Using Metra's 86-5618, pull the factory head unit from the dash and disconnect the wiring.

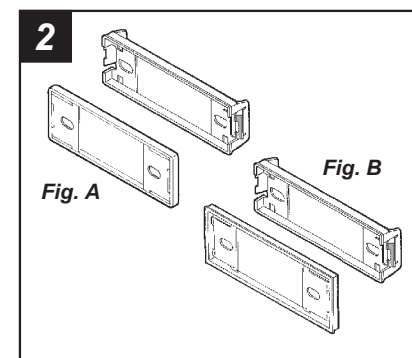

2
Locate the **Snap-in Bracket** and **Rounded Faceplate** (see Fig. A) OR the **Snap-in Bracket** and **Cornered Faceplate** (see Fig. B). Skip to the Installation Instructions for ALL VEHICLES on Page#21.

FORD Festiva 1988-93

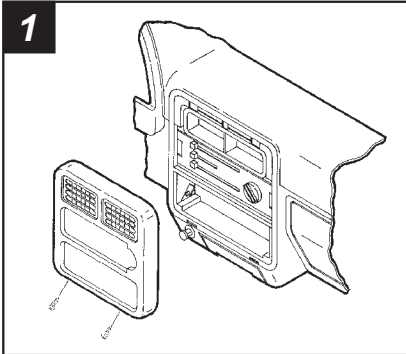

1 Disconnect the negative battery terminal to prevent an accidental short circuit. Remove (4) Phillips screws from the bottom of the dash trim bezel. Remove the bezel. Remove (2) screws securing the factory head unit and disconnect the wiring.

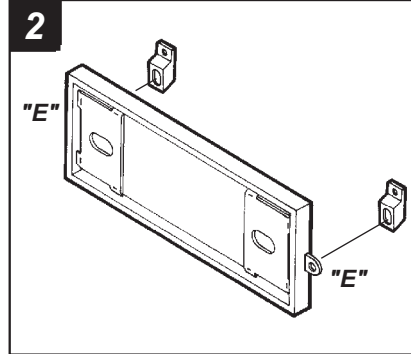

2 Cut and remove all mounting tabs on the **Radio Housing** EXCEPT tabs "E". The mounting tabs can be identified by the stamped letter on the back of each tab. Locate **Spacer Set #1**. (The Spacers must be placed behind the mounting tabs during installation in step #5). *Skip to the Installation Instructions for ALL VEHICLES on Page#22.*

JEEP Cherokee 1996

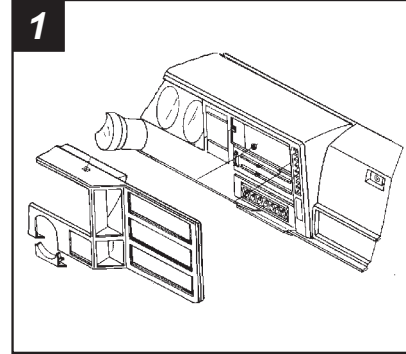

1 Disconnect the negative battery terminal to prevent an accidental short circuit. Remove (3) torx-head screws from the steering column trim panels. Unscrew the tilt steering lever and unsnap the trim panels. Remove (4) screws from the dash trim bezel and remove the bezel. Remove (2) screws securing the factory head unit and disconnect the wiring.

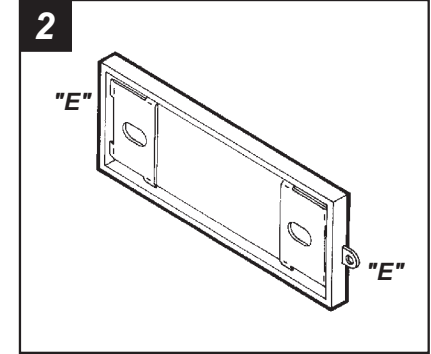

2 Cut and remove all mounting tabs on the **Radio Housing** EXCEPT tabs "E". The mounting tabs can be identified by the stamped letter on the back of each tab. *Skip to the Installation Instructions for ALL VEHICLES on Page#22.*

FORD Mustang 1994-00

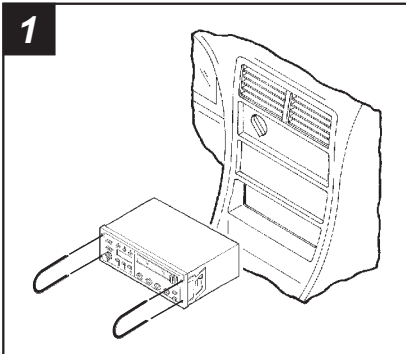

1 Disconnect the negative battery terminal to prevent an accidental short circuit. Using Metra's **86-5618**, pull the factory head unit from the dash and disconnect the wiring.

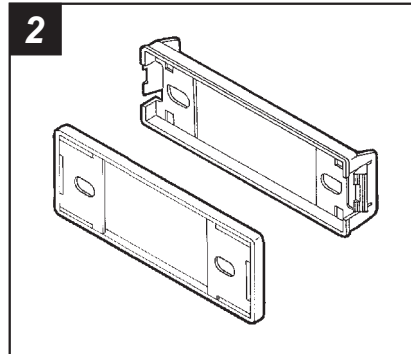

2 Locate the **Snap-in Bracket and Rounded Faceplate**. *Skip to the Installation Instructions for ALL VEHICLES on Page #21.*

JEEP Grand Wagoneer 1987-95

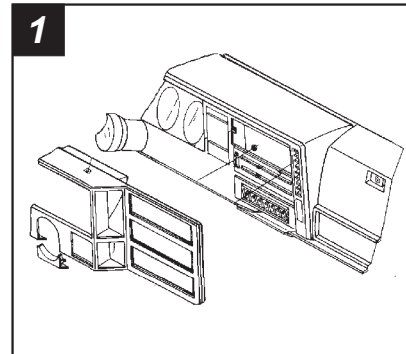

1 Disconnect the negative battery terminal to prevent an accidental short circuit. Gently unclip the dash trim bezel. Remove (2) screws securing the factory head unit and disconnect the wiring.

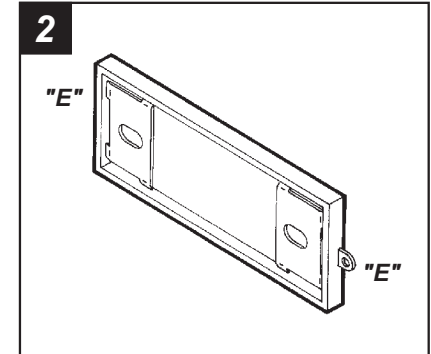

2 Cut and remove all mounting tabs on the **Radio Housing** EXCEPT tabs "E". The mounting tabs can be identified by the stamped letter on the back of each tab. *Skip to the Installation Instructions for ALL VEHICLES on Page#22.*

FORD Windstar 1995-98

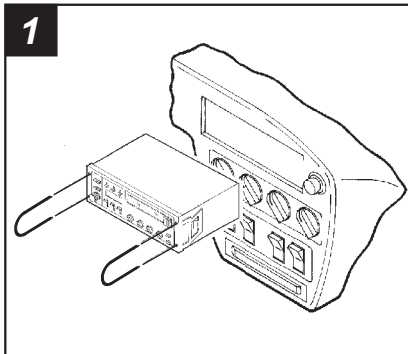

1
Disconnect the negative battery terminal to prevent an accidental short circuit. Using Metra's **86-5618**, pull the factory head unit from the dash and disconnect the wiring.

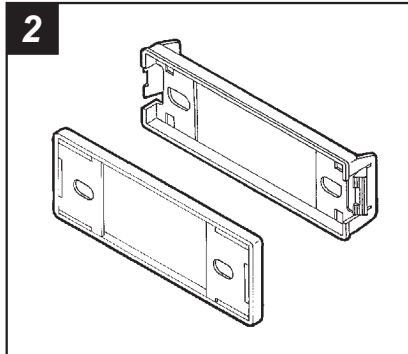

2
Locate the **Snap-in Bracket** and **Rounded Faceplate**. Skip to the *Installation Instructions for ALL VEHICLES on Page #21*.

FORD Probe 1993-97

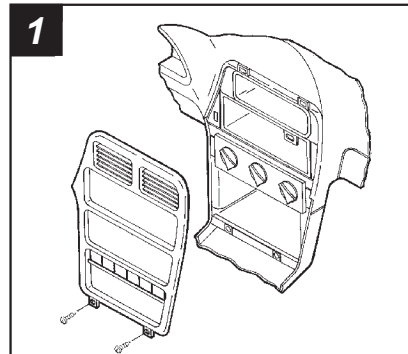

1
Disconnect the negative battery terminal to prevent an accidental short circuit. Remove (2) screws from the base of the dash trim bezel. Unclip and remove the bezel. Using Metra's **86-5618**, pull the factory head unit from the dash and disconnect the wiring.

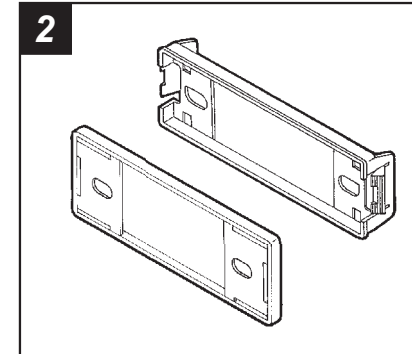

2
Locate the **Snap-in Bracket** and **Rounded Faceplate**. Skip to the *Installation Instructions for ALL VEHICLES on Page #21*.

JEEP Cherokee 1984-95 / Comanche 1986-92 Wagoneer 1984-96

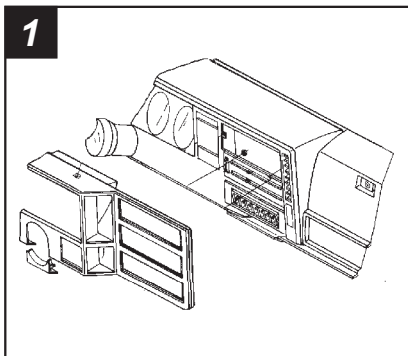

1
Disconnect the negative battery terminal to prevent an accidental short circuit. Unsnap the steering column trim panel and remove. Remove (4) screws from the dash trim bezel and remove the bezel. Remove (2) screws securing the factory head unit and disconnect the wiring.

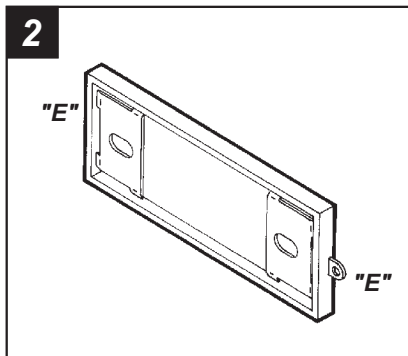

2
Cut and remove all mounting tabs on the **Radio Housing** EXCEPT tabs "E". The mounting tabs can be identified by the stamped letter on the back of each tab. Skip to the *Installation Instructions for ALL VEHICLES on Page#22*.

FORD Taurus / MERCURY Sable 1990-95

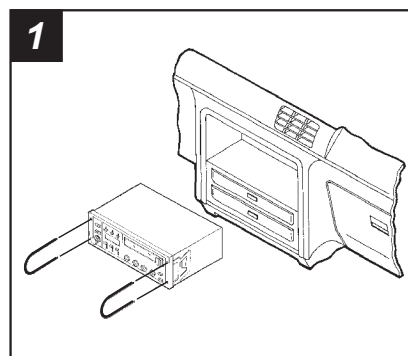

1
Disconnect the negative battery terminal to prevent an accidental short circuit. Using Metra's **86-5618**, pull the factory head unit from the dash and disconnect the wiring.

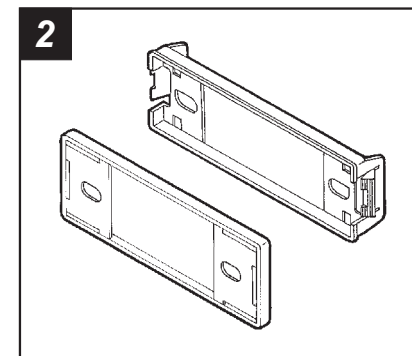

2
Locate the **Snap-in Bracket** and **Rounded Faceplate**. Skip to the *Installation Instructions for ALL VEHICLES on Page #21*.

FORD Taurus / MERCURY Sable 1986-89

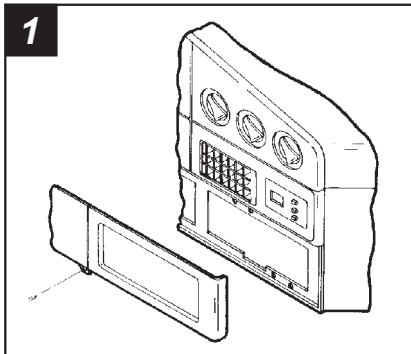

1 Disconnect the negative battery terminal to prevent an accidental short circuit. Remove (1) 7mm hex-head screw from the bottom of the radio trim bezel. Gently unclip the bezel and disconnect the antenna switch power lead. Remove (4) screws securing the factory head unit and disconnect the wiring.

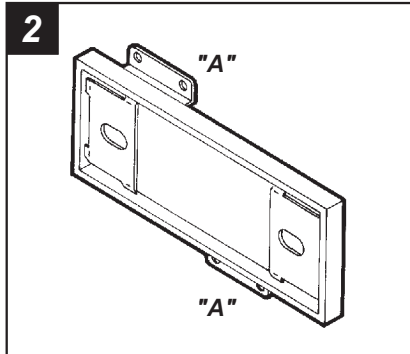

2 Cut and remove all mounting tabs on the Radio Housing EXCEPT tabs "A". The mounting tabs can be identified by the stamped letter on the back of each tab. Skip to the Installation Instructions for ALL VEHICLES on Page#22.

FORD Thunderbird / MERCURY Cougar 1989-97

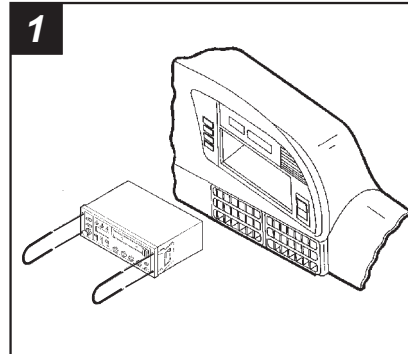

1 Disconnect the negative battery terminal to prevent an accidental short circuit. Using Metra's 86-5618, pull the factory head unit from the dash and disconnect the wiring.

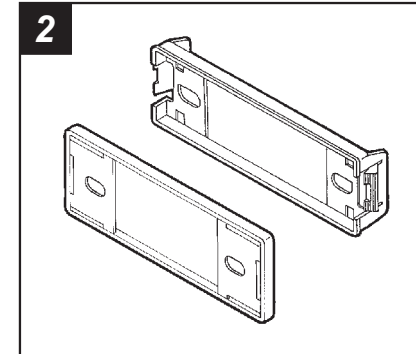

2 Locate the **Snap-in Bracket** and **Rounded Faceplate**. Skip to the Installation Instructions for ALL VEHICLES on Page #21.

FORD Tempo / MERCURY Topaz 1989-94

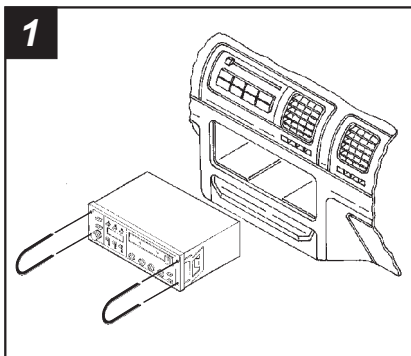

1 Disconnect the negative battery terminal to prevent an accidental short circuit. Using Metra's 86-5618, pull the factory head unit from the dash and disconnect the wiring.

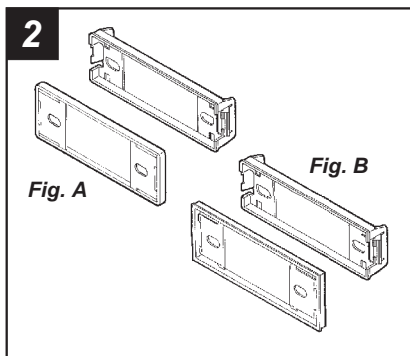

2 Locate the **Snap-in Bracket** and **Rounded Faceplate** (see Fig. A) OR the **Snap-in Bracket** and **Cornered Faceplate** (see Fig. B). Skip to the Installation Instructions for ALL VEHICLES on Page#21.

FORD Thunderbird / MERCURY Cougar 1985-88

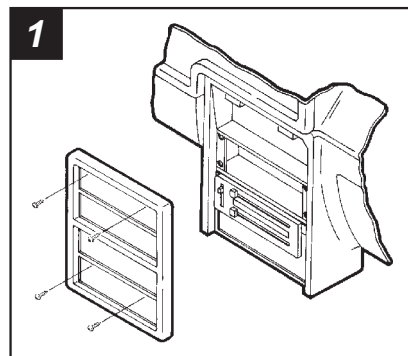

1 Disconnect the negative battery terminal to prevent an accidental short circuit. Remove (2) screws from the top of the dash trim bezel. Open the ashtray and remove (2) screws from the ashtray cavity. Remove (4) screws securing the factory head unit and

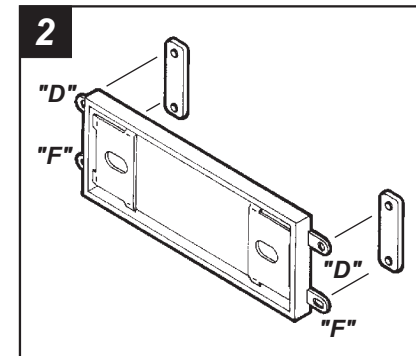

2 Cut and remove all mounting tabs on the **Radio Housing** EXCEPT tabs "D" and "F". The mounting tabs can be identified by the stamped letter on the back of each tab. Locate **Spacer Set #2**. (The Spacers must be placed behind the mounting tabs during installation in step #5). Skip to the Installation Instructions for ALL VEHICLES on Page#22.