



INSTALLATION INSTRUCTIONS FOR PART 99-2006

APPLICATIONS

Cadillac 2003-2007 99-2006/99-2006G

KIT FEATURES

- DIN radio provision with pocket
- ISO mount radio provision with pocket
- Double DIN radio provision
- Stacked ISO mount unit provision
- Stacked DIN head unit provision
- **Painted To Match Factory Dash**
99-2006 - Black, 99-2006G - Grey



KIT COMPONENTS

- A) Radio housing • B) DDIN Brackets • C) DDIN Trim plate • D) ISO Brackets • E) Trim plate
- F) (8) Phillips screws • G) Pocket

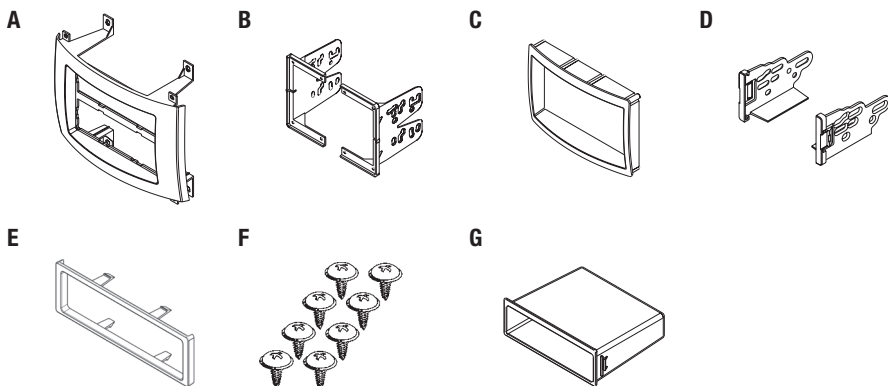

TOOLS REQUIRED

- Phillips screwdriver • Small flat blade screwdriver • Socket wrench



METRA. THE WORLD'S BEST KITS.™



1-800-221-0932



metraonline.com

© COPYRIGHT 2004-2011 METRA ELECTRONICS CORPORATION

INST99-2006

REV. 8/23/2012



99-2006

Table of Contents

Dash Disassembly

– Cadillac CTS 2003-2007	3
– Cadillac SRX 2004-2006	3

Kit Assembly

– DIN radio provision with pocket	4
– ISO mount radio provision with pocket.....	4
– Double DIN radio provision	5
– Stacked ISO mount unit provision	6
– Stacked DIN head unit provision	6

CAUTION: *Metra recommends disconnecting the negative battery terminal before beginning any installation. All accessories, switches, and especially air bag indicator lights must be plugged in before reconnecting the battery or cycling the ignition.*

Note: *Refer to the instructions included with the aftermarket radio.*



KNOWLEDGE IS POWER

Enhance your installation and fabrication skills by enrolling in the most recognized and respected mobile electronics school in our industry. Log onto www.installerinstitute.com or call 800-354-6782 for more information and take steps toward a better tomorrow.



Metra recommends MECP certified technicians

Cadillac CTS 2003-2007/SRX 2004-2006

1. Unclip and remove the center air vent assembly above the radio. (Figure A)
2. Open ashtray and remove (1) Phillips head screw from inside ashtray.
3. Unclip and remove the A/C control/ashtray assembly below the radio. (Figure B)
4. Remove (4) 10mm screws securing the radio to the dash. (Figure C, D)

Continued on next page

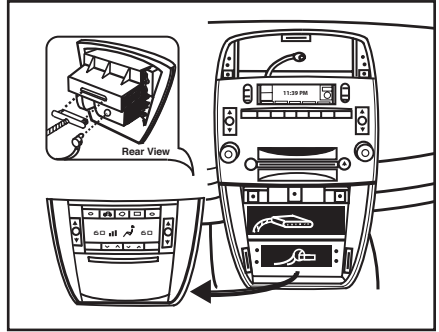

(Figure B)

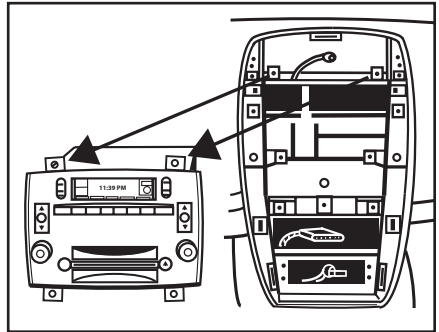

(Figure C)

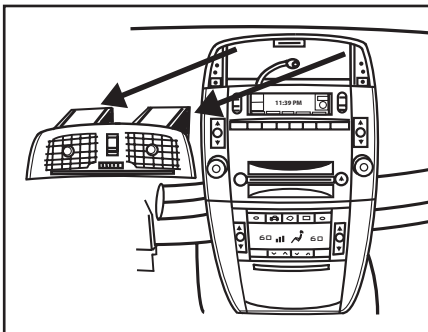

(Figure A)

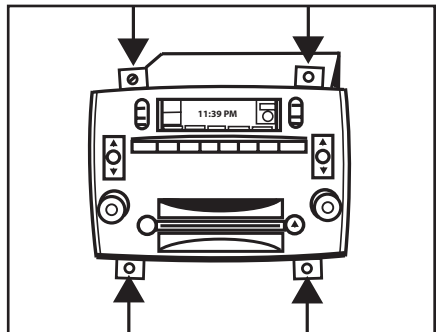

(Figure D)



Kit Assembly 99-2006

DIN radio provision with pocket

1. Slide the DIN cage into the Radio Housing and secure by bending the metal locking tabs down. (Figure A)
2. Slide the aftermarket head unit into the cage and secure. (Figure B)
3. Slide the supplied pocket into the unused opening.
4. Locate the factory wiring harness in the dash. Metra recommends using the proper mating adapter from Metra or AXXESS. Re-connect the negative battery terminal and test the unit for proper operation.
5. Reassemble dash in reverse order of disassembly.

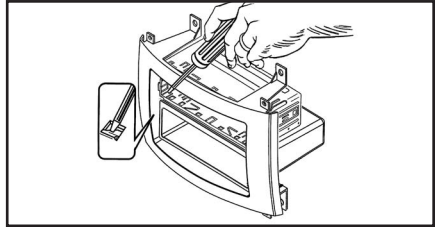

(Figure A)

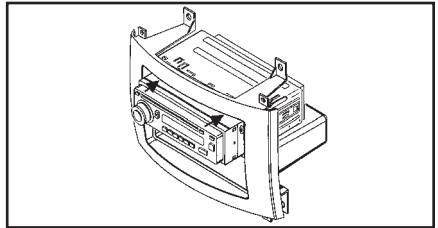

(Figure B)

ISO mount radio provision with pocket

1. Mount the ISO Brackets to the head unit with the screws supplied with the unit. (Figure A)
2. Slide the head unit into the radio opening until the side clips engage. Then snap the Trim plate into the Radio Housing. (Figure B)
3. Slide the supplied pocket into the unused opening.
4. Locate the factory wiring harness in the dash. Metra recommends using the proper mating adapter from Metra or AXXESS. Re-connect the negative battery terminal and test the unit for proper operation.
5. Reassemble dash in reverse order of disassembly.

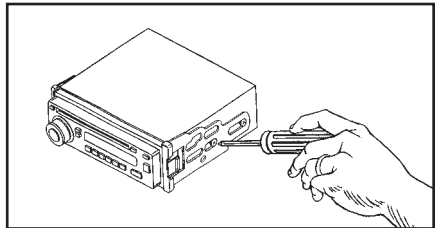

(Figure A)

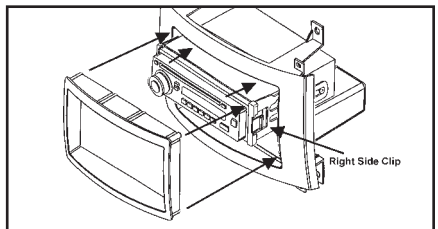

(Figure B)



Kit Assembly 99-2006

Double DIN radio provision

1. Remove the center bar from the 99-2006 radio housing. (Figure A)
2. Attach the corresponding bracket to the DDIN head unit. (Figure B)
3. Insert the DDIN trim plate into the radio housing. (Figure C)
4. Position the bracket/radio assembly to the back of the radio housing and secure with the (8) Phillips screws provided. (Figure D)
5. Locate the factory wiring harness in the dash. Metra recommends using the proper mating adapter from Metra or AXCESS. Re-connect the negative battery terminal and test the unit for proper operation.
6. Reassemble dash in reverse order of disassembly.

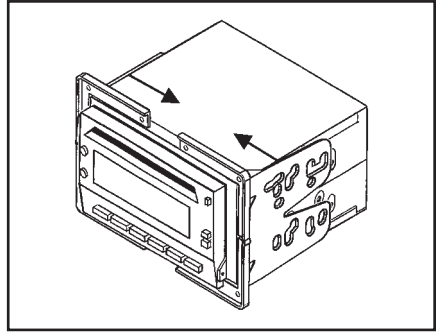

(Figure B)

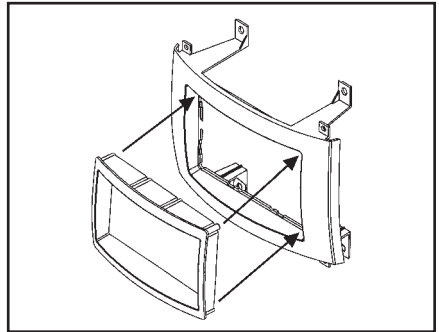

(Figure C)

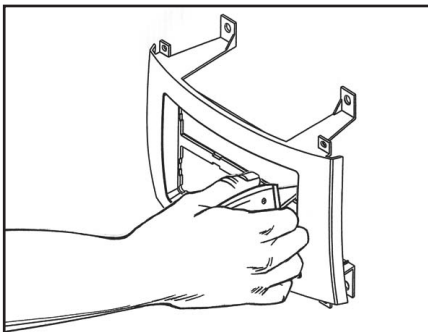

(Figure A)

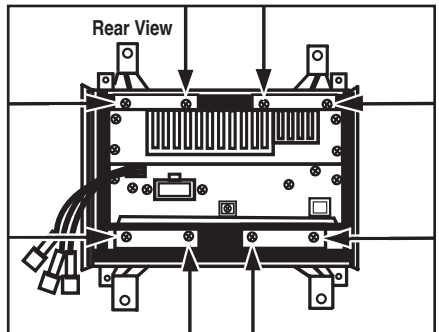

(Figure D)



Kit Assembly 99-2006

Stacked ISO mount unit provision

1. Mount the ISO Brackets to the head units with the screws supplied with the unit. (Figure A)
2. Slide the head units into the radio openings until the side clips engage. (Figure B)
3. Snap the Trim plate into the Radio Housing. (Figure B)
4. Locate the factory wiring harness in the dash. Metra recommends using the proper mating adapter from Metra or AXCESS. Re-connect the negative battery terminal and test the unit for proper operation.
5. Reassemble dash in reverse order of disassembly.

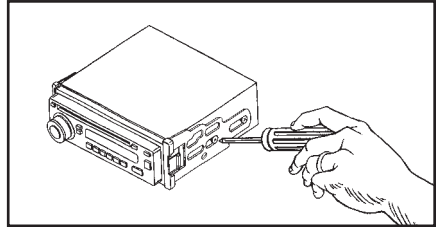

(Figure A)

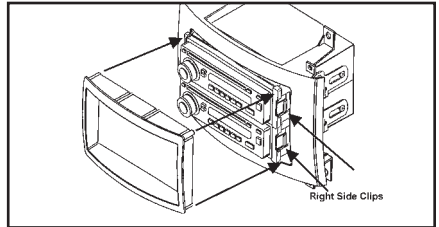

(Figure B)

Stacked DIN head unit provision

1. Slide the DIN cages into the Radio Housing and secure by bending the metal locking tabs outward. (Figure A)
2. Slide the aftermarket head units into the cages and secure. (Figure B)
3. Locate the factory wiring harness in the dash. Metra recommends using the proper mating adapter from Metra or AXCESS. Re-connect the negative battery terminal and test the unit for proper operation.
4. Reassemble dash in reverse order of disassembly.

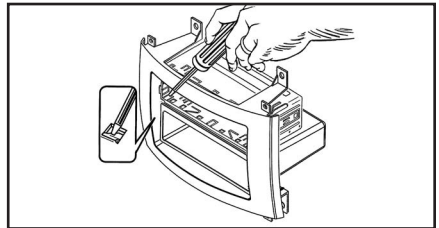

(Figure A)

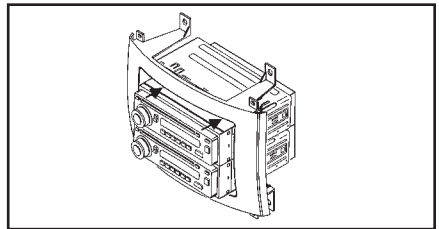

(Figure B)



INSTALLATION INSTRUCTIONS FOR PART 99-2006

INST99-2006

REV. 8/23/2012



1-800-221-0932



metraonline.com

© COPYRIGHT 2004-2011 METRA ELECTRONICS CORPORATION