



## INSTALLATION INSTRUCTIONS FOR PART 99-7321

### APPLICATIONS

See application list inside

# Hyundai Accent, Kia Rio/Rio5 2006-2011 99-7321

### KIT FEATURES

- DIN radio provision with pocket
- ISO DIN radio provision with pocket



### KIT COMPONENTS

- A) Radio housing
- B) ISO Brackets
- C) Trim plate

A

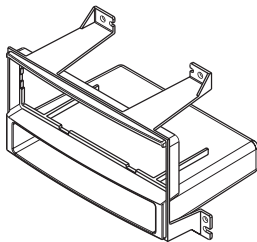

B

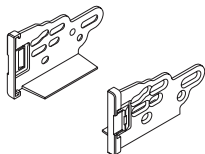

C

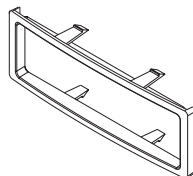

### WIRING & ANTENNA CONNECTIONS (sold separately)

#### Wiring Harness:

- 70-7303 - Hyundai/KIA harness 2009
- 70-1004 - Hyundai 2006-up/KIA harness 2004-up

#### Antenna Adapter:

- 40-K111 - KIA antenna adapter 2007-up

### TOOLS REQUIRED

- Panel removal tool
- Phillips screwdriver
- Cutting tool

**CAUTION:** Metra recommends disconnecting the negative battery terminal before beginning any installation. All accessories, switches, and especially air bag indicator lights must be plugged in before reconnecting the battery or cycling the ignition.

**NOTE:** Refer to the instructions included with the aftermarket radio.

## Table of Contents

### Dash Disassembly

– Hyundai Accent 2006-2011.....	2
– Kia Rio/Rio5 2006-2011.....	2

### Kit Assembly

– DIN radio provision with pocket.....	3
– ISO DIN radio provision with pocket.....	3

## Dash Disassembly

1. Unclip and remove the trim panel surrounding the radio and including the A/C vents. (Figure A)
2. Remove (4) Phillips screws securing the radio. (Figure B)
3. Disconnect and remove radio. (Figure B)

*Continue to kit assembly*

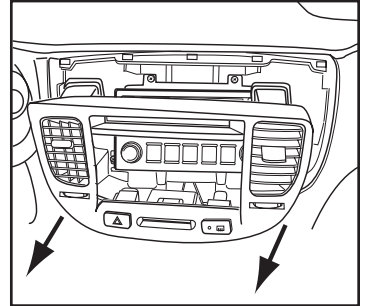

(Figure A)

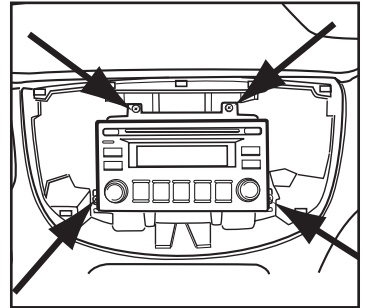

(Figure B)

## DIN radio provision with pocket

- 1. Kia Rio:** Cut and remove shaded areas #1. (Figure A)  
**Hyundai Accent:** Cut and remove shaded areas #2. (Figure A)
- Slide the DIN cage into the radio housing and secure by bending the metal locking tabs down. (Figure B)
- Slide the aftermarket radio into the cage until secure. (Figure C)
- Locate the factory wiring harness in the dash. Metra recommends using the proper mating adapter from Metra or AXCESS. Re-connect the negative battery terminal and test the radio for proper operation.
- Reassemble dash in reverse order of disassembly.

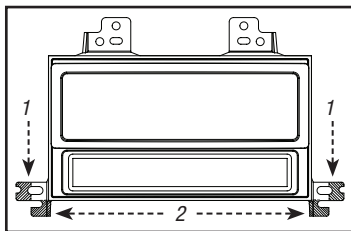

(Figure A)

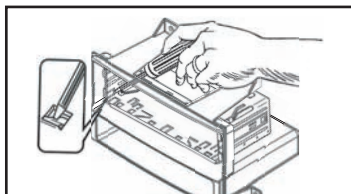

(Figure B)

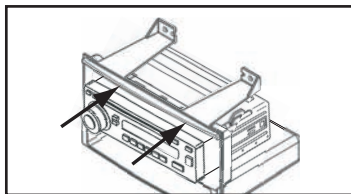

(Figure B)

## ISO DIN radio provision with pocket

- 1. Kia Rio:** Cut and remove shaded areas #1. (Figure A)  
**Hyundai Accent:** Cut and remove shaded areas #2. (Figure A)
- Mount the ISO brackets to the radio with the screws supplied with the radio. (Figure B)
- Slide the radio into the radio opening until the side clips engage. (Figure C)
- Snap the trim plate into the radio housing. (Figure C)
- Locate the factory wiring harness in the dash. Metra recommends using the proper mating adapter from Metra or AXCESS. Re-connect the negative battery terminal and test the radio for proper operation.
- Reassemble dash in reverse order of disassembly.

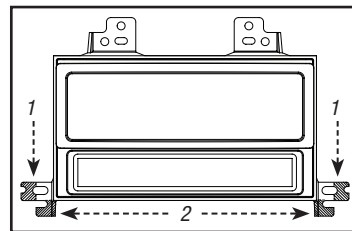

(Figure A)

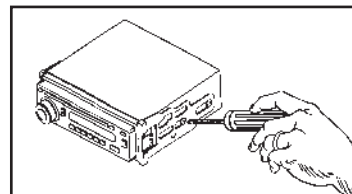

(Figure B)

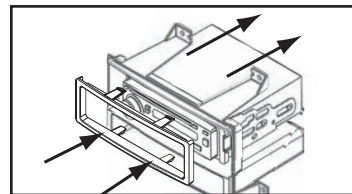

(Figure B)



## INSTALLATION INSTRUCTIONS FOR PART 99-7321



REV. 7/31/2014 INST99-7321



### KNOWLEDGE IS POWER

Enhance your installation and fabrication skills by enrolling in the most recognized and respected mobile electronics school in our industry. Log onto [www.installerinstitute.com](http://www.installerinstitute.com) or call 800-354-6782 for more information and take steps toward a better tomorrow.



**Metra recommends MECP  
certified technicians**