



INSTALLATION INSTRUCTIONS FOR PART 99-8216

APPLICATIONS

Toyota Yaris 2007-2011

(Excludes models equipped with power package)

99-8216



KIT FEATURES

- DIN radio provision with pocket
- ISO DIN radio provision with pocket

KIT COMPONENTS

- A) Radio housing
- B) Housing brackets-3 door
- C) Housing brackets-4 door
- D) ISO Snap in brackets
- E) Trim plate

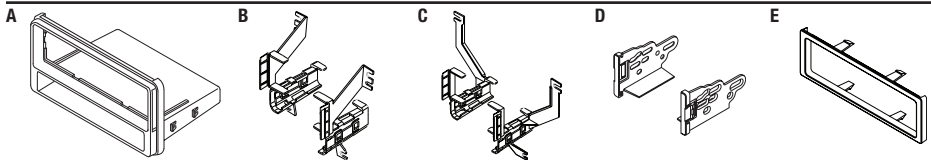

WIRING & ANTENNA CONNECTIONS (sold separately)

Wiring Harness: • 70-1761 Toyota harness 1987-up • TYT0-01 Toyota amp interface 2003-up

Antenna Adapter: • Not required

TOOLS REQUIRED

- Panel removal tool
- Phillips screwdriver
- Small flat blade screwdriver
- Socket wrench

Table of Contents

Dash Disassembly

– Toyota Yaris 2007-2011 2

Kit Assembly

– DIN radio provision with pocket 2-3

– ISO DIN radio provision with pocket 3

CAUTION: Metra recommends disconnecting the negative battery terminal before beginning any installation. All accessories, switches, and especially air bag indicator lights must be plugged in before reconnecting the battery or cycling the ignition.

NOTE: Refer to the instructions included with the aftermarket radio.

Dash Disassembly

1. Unclip the bottom trim panel located underneath the A/C Controls. (Figure A)
2. Unclip the two side trim panels that surround the A/C controls and radio. (Figure A)
3. Unclip the Instrument trim panel surrounding the speedometer and gauges. (Figure B)
4. Unclip the Radio/AC vents trim panel. (Figure B)
5. Remove (4) Phillips screws securing radio. (Figure C)
6. Unplug and remove radio.

Continue to kit assembly

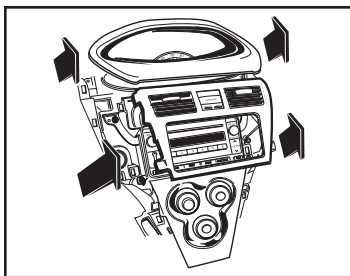

(Figure B)

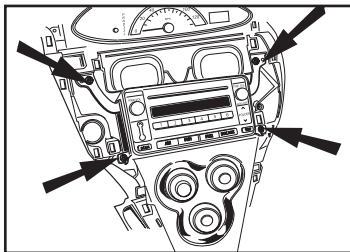

(Figure C)

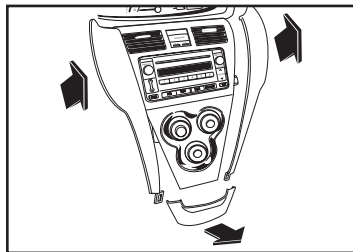

(Figure A)

Kit Assembly

DIN radio provision with pocket

1. Locate the factory wiring harness in the dash. Metra recommends using the proper mating adapter from Metra or AXCESS. Re-connect the negative battery terminal and test the unit for proper operation.
2. Slide the mounting brackets onto the sides of the radio housing until the side clips engage.

Note: Tabs are marked 8216-3L and R for the 3 door Yaris and 8216-4L and R for the 4 door Yaris. (Figure A)

3. Slide the DIN cage into the radio housing and secure by bending the metal locking tabs outward. (Figure B)

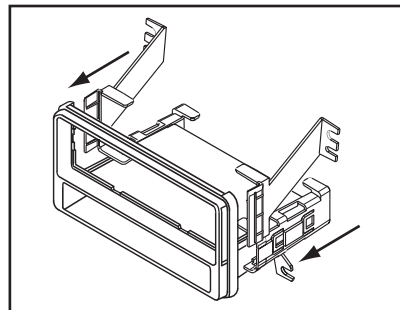

(Figure A)

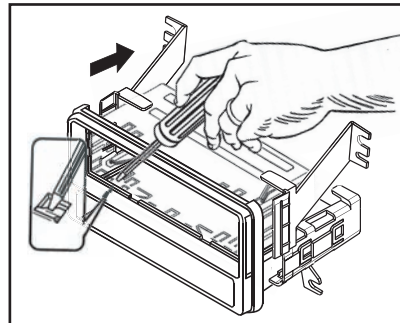

(Figure B)

Kit Assembly

DIN radio provision with pocket (Continued)

- Slide the aftermarket radio into the cage until it snaps into place. (Figure C)
- Reassemble dash in reverse order of disassembly.

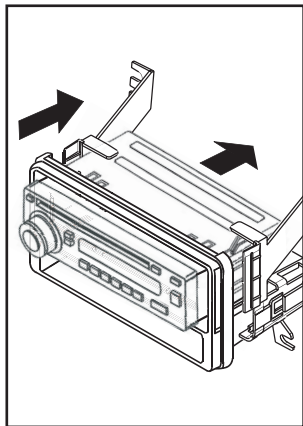

(Figure C)

ISO DIN radio provision with pocket

- Locate the factory wiring harness in the dash. Metra recommends using the proper mating adapter from Metra or AXXESS. Re-connect the negative battery terminal and test the unit for proper operation.
- Slide the mounting brackets onto the sides of the radio housing until the side clips engage.

Note: Tabs are marked 8216-3L and R for the 3 door Yaris and 8216-4L and R for the 4 door Yaris. (Figure A)

- Mount the ISO brackets to the aftermarket radio using the screws supplied with the radio. (Figure B)
- Slide the radio into the radio opening until the side clips snap into place. (Figure C)
- Snap the trim plate onto the front of the radio housing assembly. (Figure C)
- Reassemble dash in reverse order of disassembly.

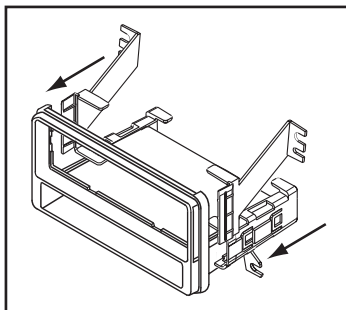

(Figure A)

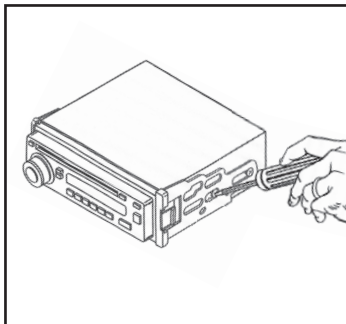

(Figure B)

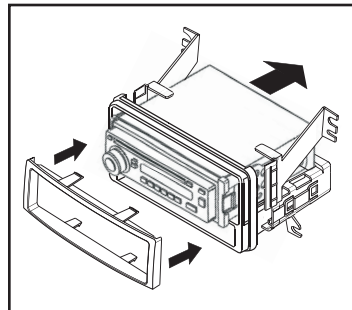

(Figure C)



INSTALLATION INSTRUCTIONS FOR PART 99-8216



REV. 4/16/2014 INST99-8216



KNOWLEDGE IS POWER

Enhance your installation and fabrication skills by enrolling in the most recognized and respected mobile electronics school in our industry. Log onto www.installerinstitute.com or call 800-354-6782 for more information and take steps toward a better tomorrow.



**Metra recommends MECP
certified technicians**