



## Toyota Camry 2015-2017

### KIT FEATURES

- ISO DIN radio provision with pocket
- ISO DDIN radio provision
- Built and painted in multiple colors to match the factory color and appearance

### KIT COMPONENTS

- A) Radio housing trim panel • B) Radio brackets • C) Pocket • D) Phillips screws (8)

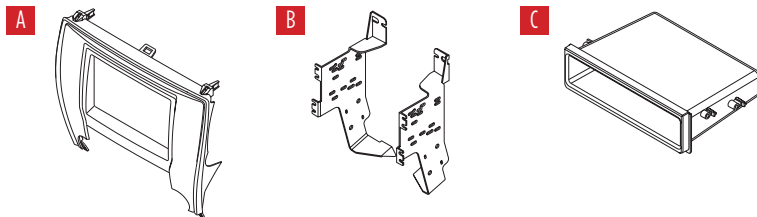

### TABLE OF CONTENTS

Dash Disassembly.....	2-3
Kit Preparation.....	4
Kit Assembly	
–ISO DIN radio provision with pocket.....	5
–ISO DDIN radio provision.....	6

### WIRING & ANTENNA CONNECTIONS (sold separately)

- Wiring Harness: 70-1761 • TYTO-02 (amplified models)
- Antenna Adapter: 40-LX11
- Steering Wheel Control Interface: ASWC-1

### TOOLS REQUIRED

- Panel removal tool • Phillips screwdriver
- 10mm socket wrench

**Attention!** Let the vehicle sit with the key out of the ignition for a few minutes before removing the factory radio. When testing the aftermarket equipment, ensure that all factory equipment is connected before cycling the key to ignition.

## DASH DISASSEMBLY

1. Unclip and remove the console storage tray. (Figure A)
2. Push down on the collar below the shift knob, then unscrew the shift knob. (Figure B)
3. Remove (2) Phillips screws from the shifter trim, then unclip and remove the trim. (Figure C)

*Continued on next page*

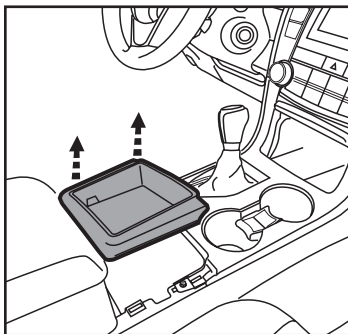

(Figure A)

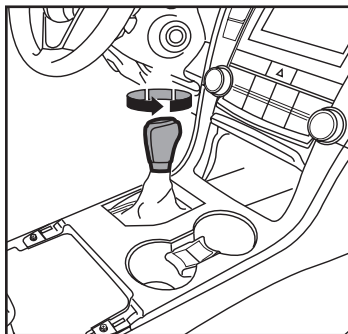

(Figure B)

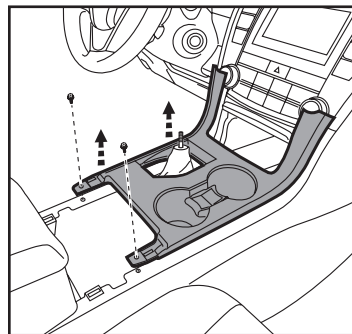

(Figure C)

## DASH DISASSEMBLY (CONT)

4. Remove (2) Phillips screws securing the factory pocket, then unclip and remove the pocket. (Figure D)
5. Unclip and remove the vent panel above the radio. (Figure E)
6. Remove (4) 10mm screws securing the radio/climate control panel (2 above and 2 below). (Figure F)
7. Slide the radio and climate control assembly out, then unplug and remove.

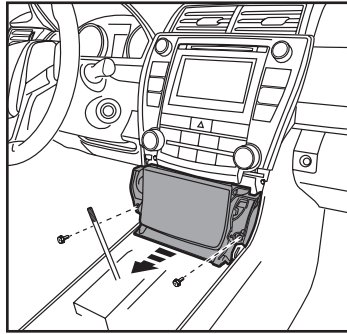

(Figure D)

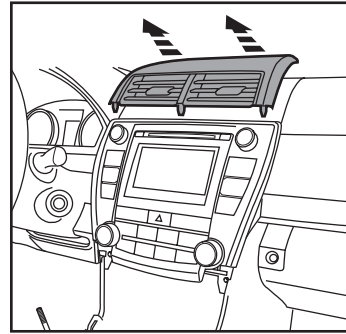

(Figure E)

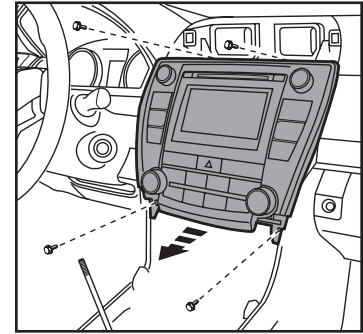

(Figure F)

*Continue to Kit Preparation*

## KIT PREPARATION

### From the factory radio/climate control panel:

1. Slightly loosen (10) Phillips screws securing the radio brackets to the radio. (Figure A)
2. Remove (4) Phillips screws securing the climate controls, then unclip and remove the controls. (Figure A)
3. Remove (2) panel clips from the radio. (Figure A)

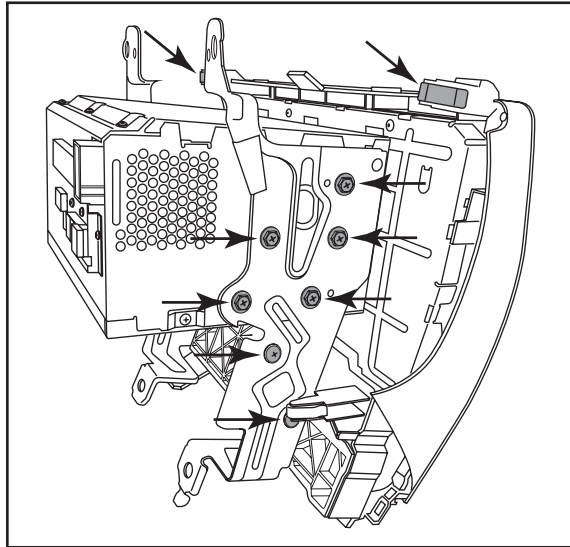

(Figure A)

### To the 99-8249 radio brackets:

4. Secure the climate controls to the brackets using the factory screws. (Figure B)

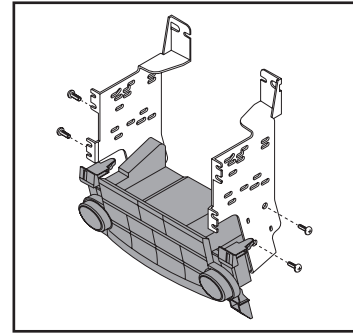

(Figure B)

### To the 99-8249 radio trim panel:

5. Attach the factory panel clips to the panel. (Figure C)

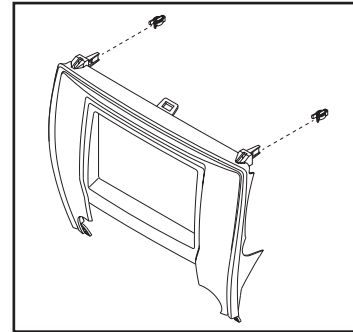

(Figure C)

*Continue to Kit Assembly*

## KIT ASSEMBLY

### ISO DIN radio provision with pocket

1. Secure the radio bracket/climate control assembly to the **radio housing trim panel** with (4) Phillips screws supplied. (Figure A)
3. Secure the **pocket** to the **bracket/panel** assembly with the (4) remaining Phillips screws supplied. (Figure B)
5. Remove the metal "DIN" sleeve and trim ring from the aftermarket radio.

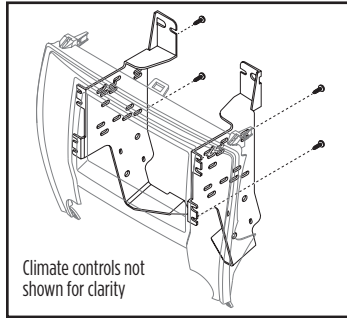

(Figure A)

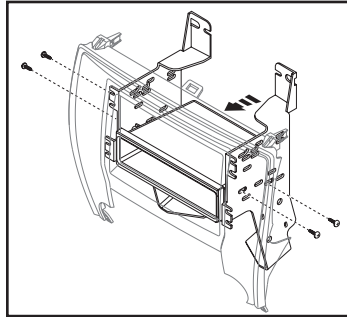

(Figure B)

6. Slide the radio into the assembly and secure with screws supplied with the radio. (Figure C)
7. Locate the factory wiring harness and antenna connector in the dash and complete all necessary connections to the radio. Metra recommends using the proper mating adapter from Metra and/or AXCESS. Test the radio for proper operation.
8. Secure the radio assembly into the dash and reassemble the dash in reverse order of disassembly.

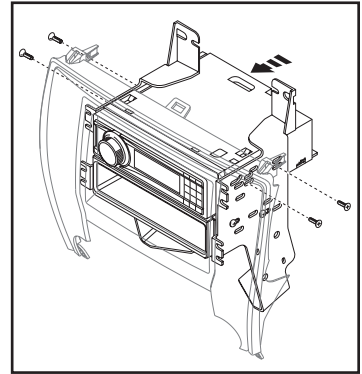

(Figure C)

## KIT ASSEMBLY

### ISO DDIN radio provision

1. Secure the radio bracket/climate control assembly to the **radio housing trim panel** with (4) Phillips screws supplied. (Figure A)
2. Slide the radio into the assembly and secure with screws supplied with the radio. (Figure B)
3. Locate the factory wiring harness and antenna connector in the dash and complete all necessary connections to the radio. Metra recommends using the proper mating adapter from Metra and/or AXXESS. Test the radio for proper operation.
4. Secure the radio assembly into the dash and reassemble the dash in reverse order of disassembly.

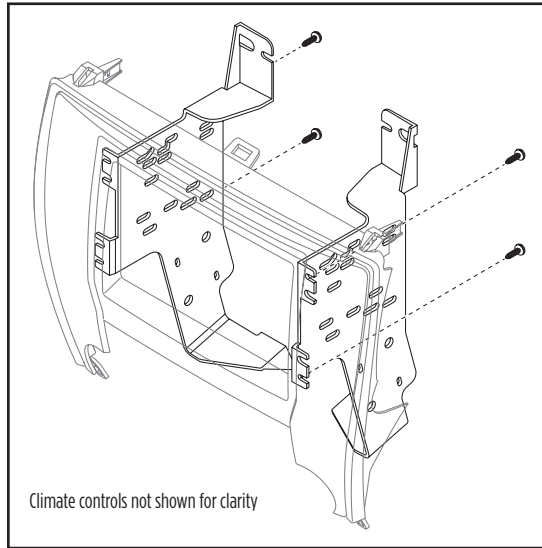

(Figure A)

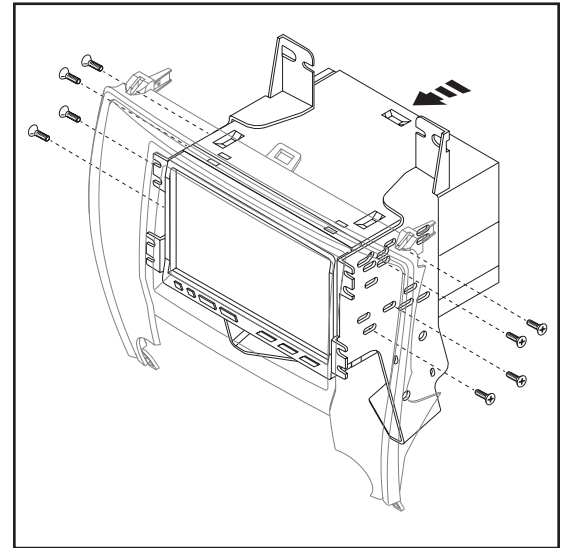

(Figure B)





**99-8249**  
INSTALLATION INSTRUCTIONS



If you are having difficulties with the installation of this product, contact our Tech Support line either by phone at **386-257-1187**, or email at **techsupport@metra-autosound.com**. Before doing so, look over the instruction booklet a second time and ensure that the installation was performed exactly as the instruction booklet is stated. Have the vehicle apart and ready to perform troubleshooting steps before contacting Metra/Axxess Tech Support.



**KNOWLEDGE IS POWER**

Enhance your installation and fabrication skills by enrolling in the most recognized and respected mobile electronics school in our industry. Log onto [www.installerinstitute.com](http://www.installerinstitute.com) or call 800-354-6782 for more information and take steps toward a better tomorrow.



**Metra recommends MECP certified technicians**