



Chrysler SWC (Steering Wheel Control) and Data Interface 2004-Up

INTERFACE FEATURES

- Provides accessory power (10-amp)
- Provides wires for multimedia radios (park brake, reverse, speed sense)
- Retains audio controls on the steering wheel
- Can be used in both amplified and non-amplified models
- Retains balance and fade (†)
- Designed to be compatible with all major radio brands
- Auto detects vehicle type, radio connection, and preset controls
- Ability to dual assign steering wheel control buttons
- Retains memory settings even after battery disconnection or interface removal (non volatile memory)
- Provides illumination output
- Micro-B USB updatable

(†) Non-amplified models only

INTERFACE COMPONENTS

• AXTC-CH13 interface • LD-SWCX-6502 harness • LD-SWCX-6522 harness • 3.5mm adapter

APPLICATIONS

See inside front cover

TABLE OF CONTENTS

Applications	2
Connections	
LDSWCX-6502 Without Amp.....	3
LDSWCX-6502 With Amp	4
LDSWCX-6522 Without Amp.....	5
LDSWCX-6522 With Amp.....	6
Programming.....	7
Troubleshooting.....	8

TOOLS & INSTALLATION ACCESSORIES REQUIRED

- Crimping tool and connectors, or solder gun, solder, and heat shrink
- Tape
- Wire cutter
- Zip ties

ATTENTION: With the key out of the ignition, disconnect the negative battery terminal before installing this product. Ensure that all installation connections, especially the air bag indicator lights, are plugged in before reconnecting the battery or cycling the ignition to test this product.

NOTE: Refer also to the instructions included with the aftermarket accessory before installing this device.

APPLICATIONS

LD-SWCX-6502 APPLICATIONS

Chrysler		Jeep	
300	2005-2007	Commander	2006-2007
Aspen	2007	Compass	2007-2008
PT Cruiser	2006-2010	Grand Cherokee	2005-2007
Dodge		Mitsubishi	
Caliber	2007-2008	Raider	2006-2007
Charger	2006-2007		
Dakota	2005-2007		
Durango	2004-2007		
Magnum	2005-2007		
Ram 1500	2006-2008		
Ram 2500/3500	2006-2009		
Ram Chassis Cab 4500/5500	2008-2010		

LD-SWCX-6522 APPLICATIONS

Chrysler		Jeep	
200	2011-2014	Commander	2008-2010
300	2008-2010	Compass	2009-2017.5
Aspen	2008-2009	Grand Cherokee	2008-2013
Sebring	2007-2010	Liberty	2008-2012
Town & Country	2008-2017	Patriot	2009-2017
Dodge		Mitsubishi	
Avenger	2008-2014	Wrangler*	2018
Caliber	2009-2012	Wrangler Unlimited*	2018
Caravan, Grand Caravan	2008-up	Wrangler	2007-2017
Challenger	2008-2014	Wrangler Unlimited	2007-2017
Charger	2008-2010	* JK body type	
Dakota	2008-2011	Mitsubishi	
Durango	2008-2013	Raider	
Journey	2009-2010	2008-2009	
Magnum	2008-2009	Ram	
Nitro	2007-2011	1500/2500/3500	
Ram 1500	2009-2011	2012	
Ram 2500/3500	2010-2011	Chassis Cab 3500/4500/5500	
Ram Chassis Cab 4500/5500	2011	2012	
		C/V Tradesman	
		2012-2015	
		Volkswagen	
		Routan	
		2009-2013	

LD-SWCX-6502 CONNECTIONS

Without Factory Amp

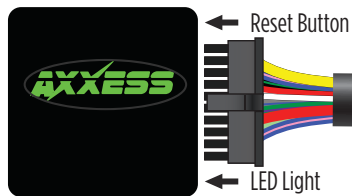

3.5mm Adapter (for vehicles without Steering wheel controls or aftermarket radios with a wire for SWC)

- Boss (with SWC wire):** Key 1 (Gray) - Brown
- Kenwood / JVC (with SWC wire):** Blue/Yellow - Brown
- XITE:** SWC-2 - Brown
- Universal Radio***
 - Key-A or SWC-1 - Brown
 - Key-B or SWC-2 - Brown/White

* After programming, assign SWC buttons within radio menu



3.5mm Adapter for Vehicles without Steering wheel controls

- 1) From the **3.5mm adapter**, tie the **Brown** and **Brown/White** wires together with tape or connector
- 2) Connect the **3.5mm adapter** to the 3.5mm jack from the **AXTC-CH13 Harness**
- 3) Program the **AXTC-CH13** per the instructions on page 7. Disregard steps 4 & 5

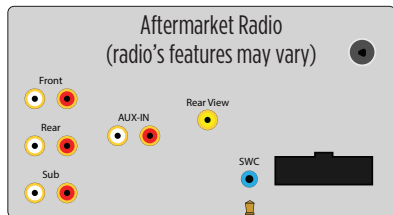

Vehicle Connector

Radio Connections

- Black** - Ground
- Yellow** - Battery power
- Red** - Accessory power
- Orange** - Illumination
- Blue** - Power Antenna
- Not Used**
- Blue/Pink** - VSS/Speed-Sense
- Green/Purple** - Reverse signal
- Light Green** - Parking brake
- Gray** - Front right speaker +
- Gray/Black** - Front right speaker -
- White** - Front left speaker +
- White/Black** - Front left speaker -
- Green** - Rear left speaker +
- Green/Black** - Rear left speaker -
- Purple** - Rear right speaker +
- Purple/Black** - Rear right speaker -

LD-SWCX-6502 CONNECTIONS

With Factory Amp

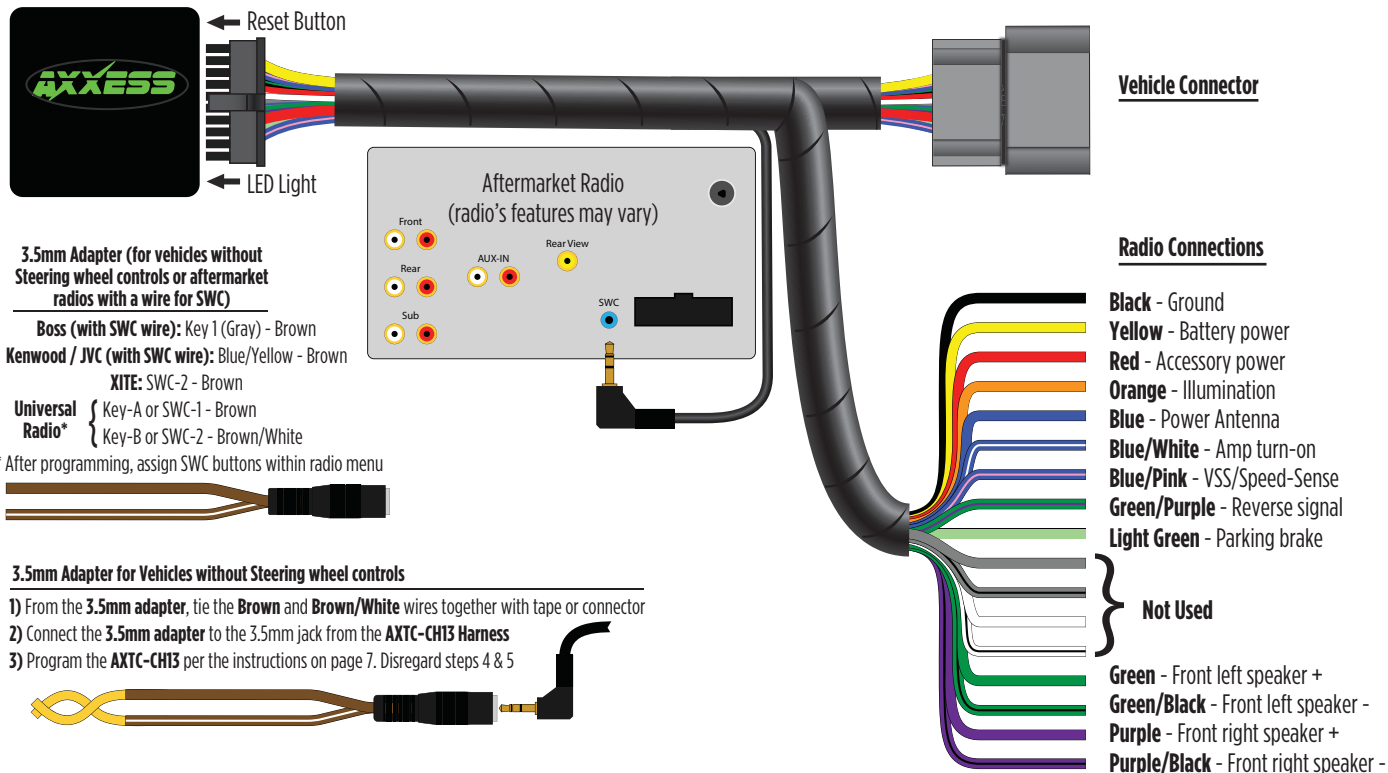

LD-SWCX-6522 CONNECTIONS

Without Factory Amp

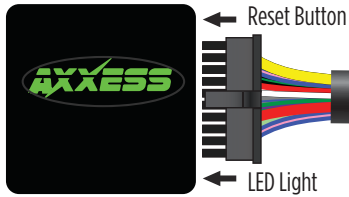

3.5mm Adapter (for vehicles without Steering wheel controls or aftermarket radios with a wire for SWC)

- Boss (with SWC wire):** Key 1 (Gray) - Brown
- Kenwood / JVC (with SWC wire):** Blue/Yellow - Brown
- XITE:** SWC-2 - Brown
- Universal Radio***
 - Key-A or SWC-1 - Brown
 - Key-B or SWC-2 - Brown/White

* After programming, assign SWC buttons within radio menu



3.5mm Adapter for Vehicles without Steering wheel controls

- 1) From the 3.5mm adapter, tie the **Brown** and **Brown/White** wires together with tape or connector
- 2) Connect the 3.5mm adapter to the 3.5mm jack from the **AXTC-CH13 Harness**
- 3) Program the **AXTC-CH13** per the instructions on page 7. Disregard steps 4 & 5

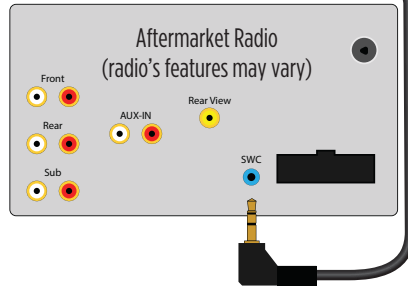

Vehicle Connector

Radio Connections

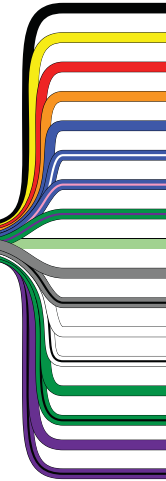

- Black** - Ground
- Yellow** - Battery power
- Red** - Accessory power
- Orange** - Illumination
- Blue** - Power Antenna
- Not Used**
- Blue/Pink** - VSS/Speed-Sense
- Green/Purple** - Reverse signal
- Light Green** - Parking brake
- Gray** - Front right speaker +
- Gray/Black** - Front right speaker -
- White** - Front left speaker +
- White/Black** - Front left speaker -
- Green** - Rear left speaker +
- Green/Black** - Rear left speaker -
- Purple** - Rear right speaker +
- Purple/Black** - Rear right speaker -

LD-SWCX-6522 CONNECTIONS

With Factory Amp

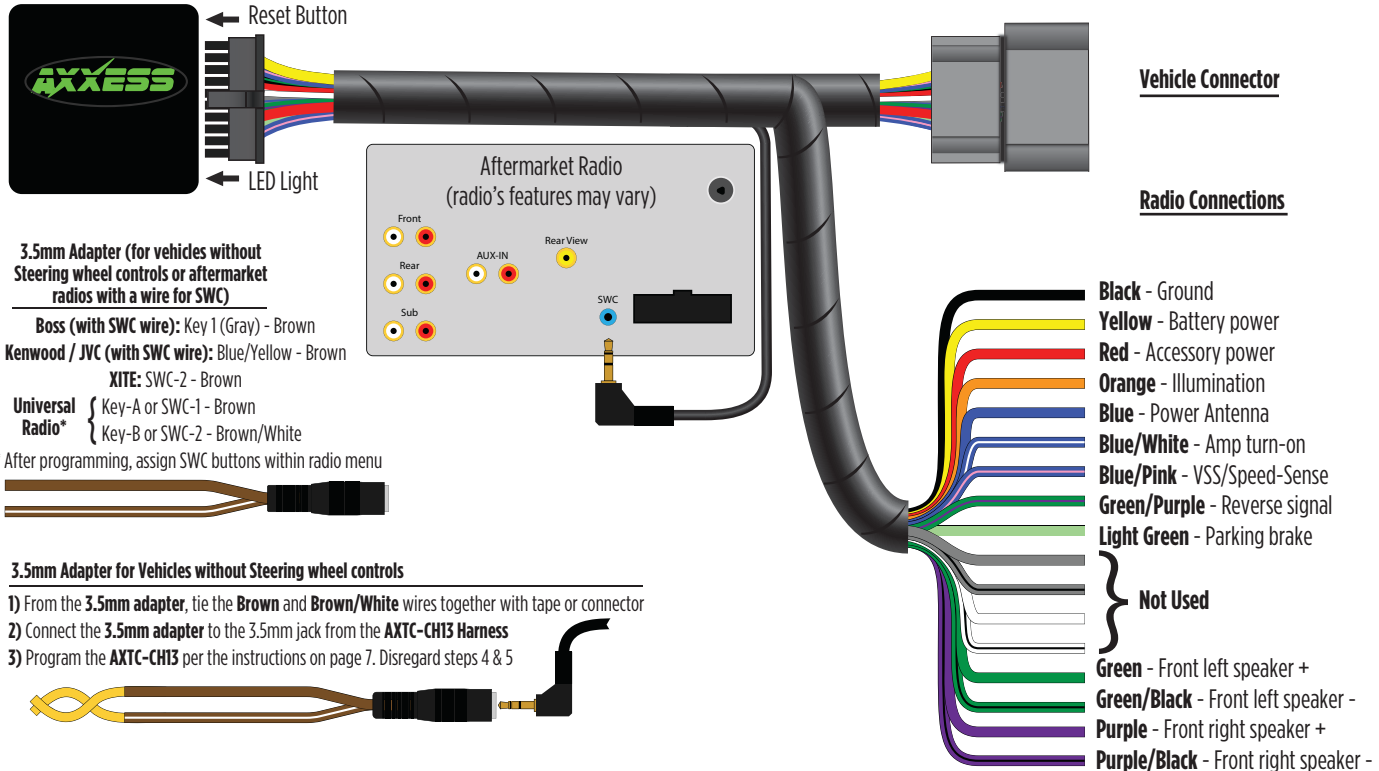

PROGRAMMING

- 

1. Open the driver's door, and keep open during the programming process.
- 

2. Cycle the ignition on.
- 

3. Connect the appropriate **LD-SWCX harness** to the **AXTC-CH13 interface**, and then to the wiring harness in the vehicle.
- 

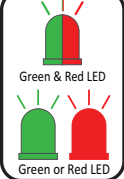
4.* Locate the **Volume Up** button behind the steering wheel on the right hand side. Program the interface by tapping the **Volume Up** button at a heartbeat pace until the LED light stops flashing.
*Only applicable if vehicle came with steering wheel controls
- 

5.* The LED light will flash **Green & Red** while the interface programs the radio to the steering wheel controls. Once programmed, the LED light will go out, then produce a pattern which will identify the radio type installed.
*Only applicable if vehicle came with steering wheel controls
- 

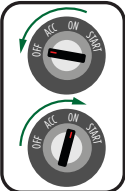
6. The LED light will go out, then once again quickly flash **Green & Red** while the interface programs itself to the vehicle. Once programmed, the LED light will go out again, then turn solid **Green**.
- 

7. Cycle the ignition off, then back on.
- 

8. Test all functions of the installation for proper operation.

TROUBLESHOOTING

1.

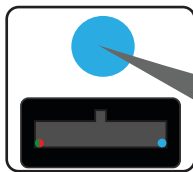

LED Light Reset Button

If the interface fails to function, press and release the reset button, then repeat the programming process from step 4 to try again.

QR Code Scan Here



Further troubleshooting steps and information can be located at:

axessinterfaces.com/product/AXTC-CH13

2.

Final LED Feedback

At the end of programming the LED light will turn **Solid Green** which indicates programming was successful. If the LED light didn't turn **Solid Green**, reference the list below to understand which programming section the problem may stem from.

LED Light	Radio Programming Section	Vehicle Programming Section
Solid Green	Pass	Pass
Slow Red Flash	Fail	Pass
Slow Green Flash	Pass	Fail
Solid Red	Fail	Fail

Note: If the LED light shows **Solid Green** for **Pass** (indicating everything programmed correctly), yet the steering wheel controls don't work, check to ensure that the 3.5mm jack is plugged in, and also plugged into the correct jack on the radio. Once corrected, press the reset button, then program again.

Having difficulties? We're here to help.



Contact our Tech Support line at:

386-257-1187



Or via email at:

techsupport@metra-autosound.com

Tech Support Hours (Eastern Standard Time)

Monday - Friday: 9:00 AM - 7:00 PM

Saturday: 10:00 AM - 7:00 PM

Sunday: 10:00 AM - 4:00 PM



KNOWLEDGE IS POWER

Enhance your installation and fabrication skills by enrolling in the most recognized and respected mobile electronics school in our industry. Log onto www.installerinstitute.edu or call 386-672-5771 for more information and take steps toward a better tomorrow.



Metra recommends MECP certified technicians